

CROSS-SECTION LOCATION

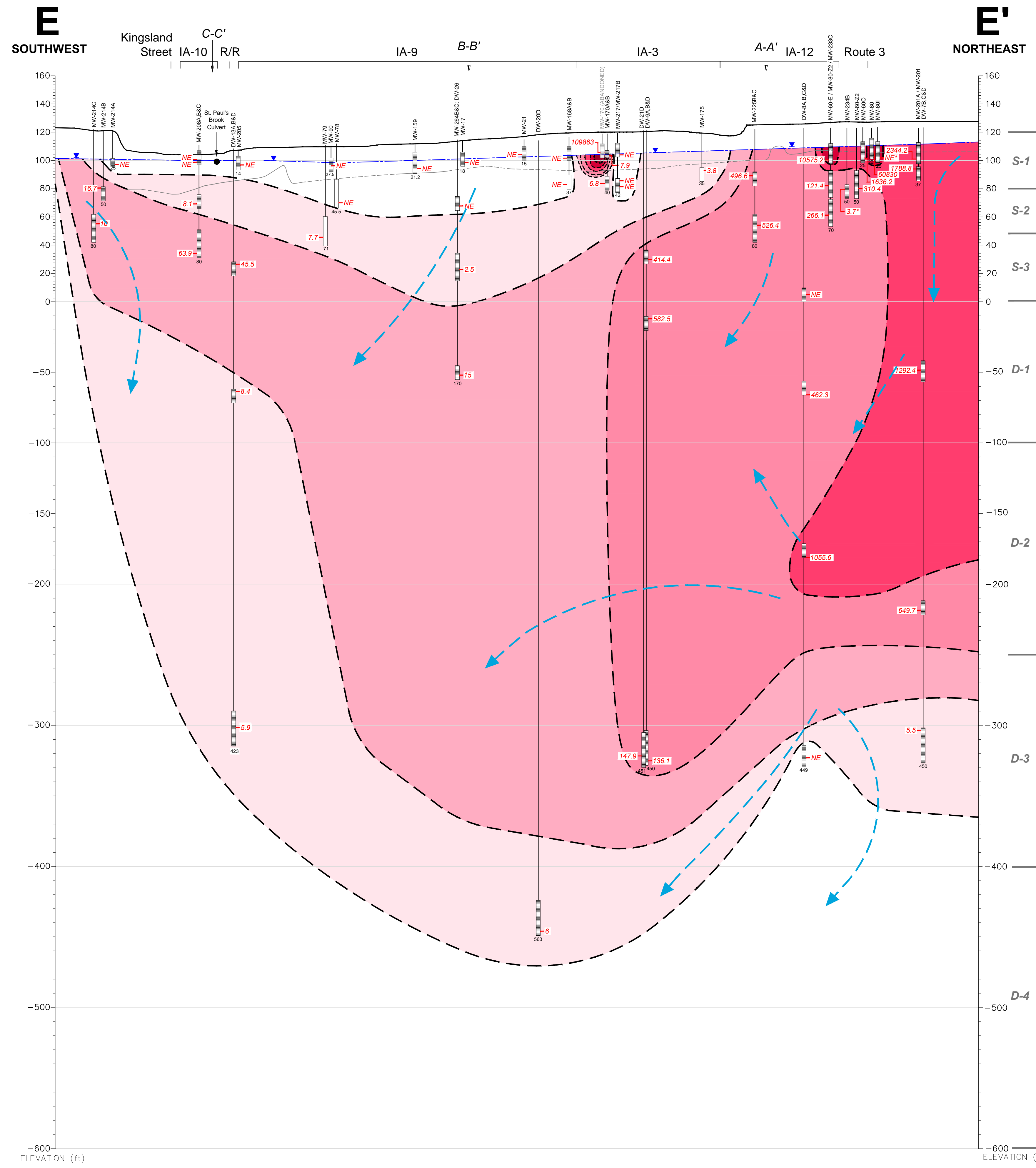

LEGEND

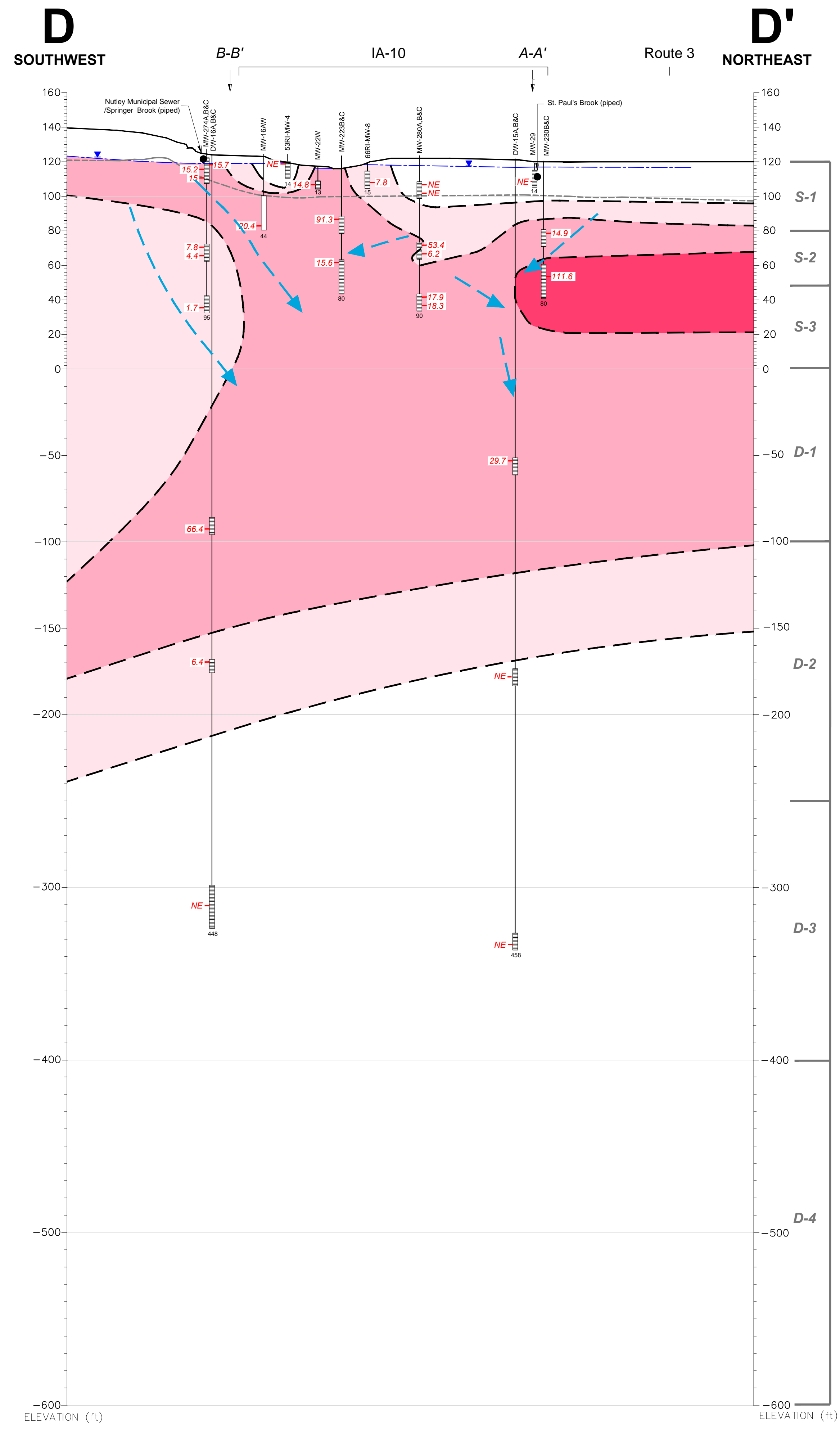
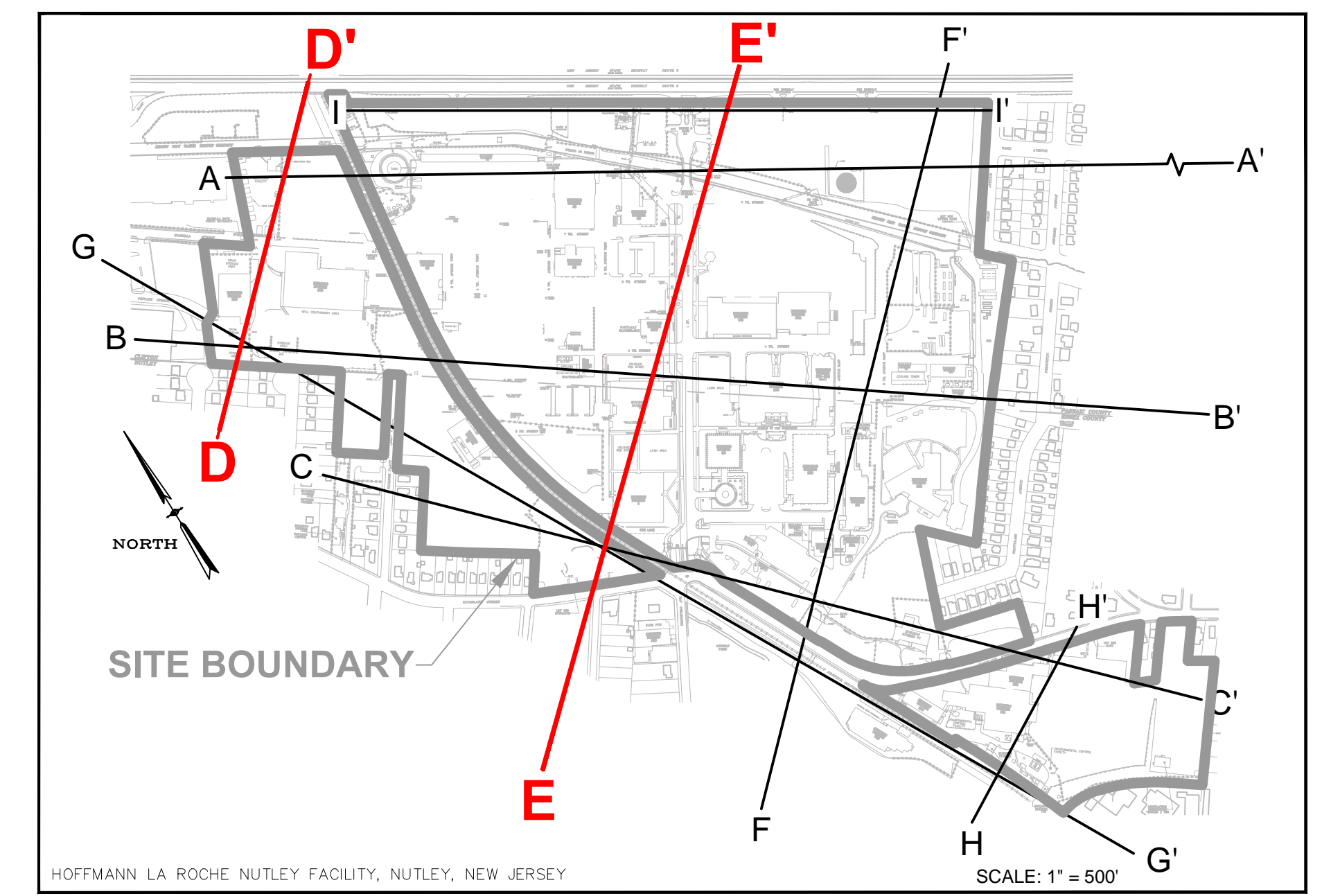
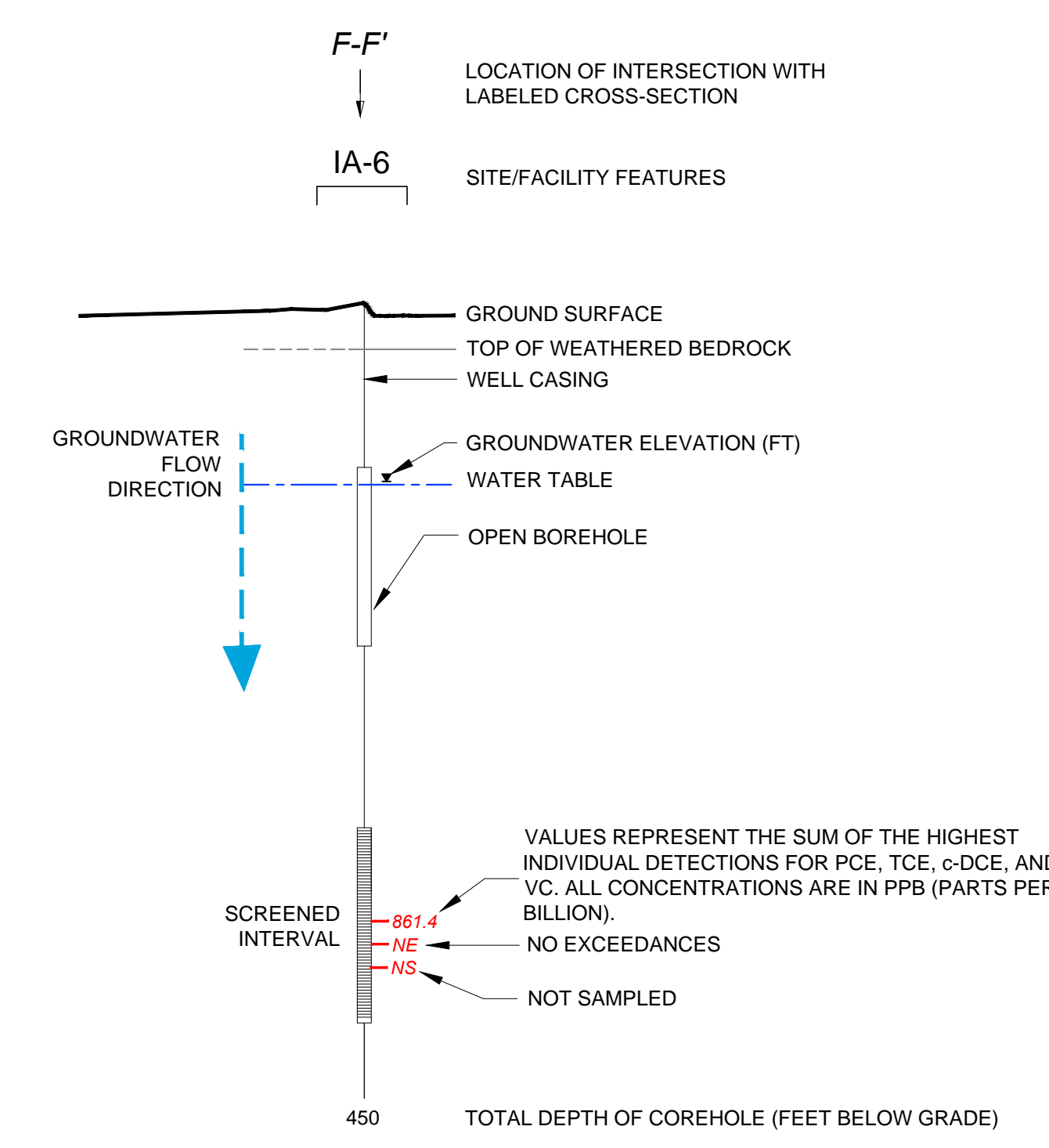

ISOCONCENTRATION CONTOURS OF PCE AND BREAKDOWN PRODUCTS (TCE, C-DCE AND VC) >GWQS*

- TOTAL CONCENTRATION > 1 PPB
- TOTAL CONCENTRATION > 10 PPB
- TOTAL CONCENTRATION > 100 PPB
- TOTAL CONCENTRATION > 1,000 PPB
- TOTAL CONCENTRATION > 10,000 PPB

NOTES:

1. COREHOLES HAVE BEEN SEALED WITH BLANK FLUTE LINERS.
2. GROUND SURFACE IS BASED UPON THE SURFACE ELEVATION ALONG D-D' AND E-E'.
3. SOME WELLS HAVE BEEN PROJECTED UP TO 300 FEET TO CONSTRUCT THIS VERTICAL SECTION AND ARE DISPLAYED AT ACTUAL SURVEYED ELEVATIONS.
4. LITHOLOGIC CONTACTS ARE DASHED WHERE INFERRED.
5. ELEVATION DATUM NAVD 1988, FEET ABOVE MEAN SEA LEVEL.
6. RR = RAILROAD.
7. ONLY CVOCs DETECTED ABOVE NJDEP GROUND WATER QUALITY STANDARD (GWQS) ARE INCLUDED IN ISOCONCENTRATION CONTOURS.
8. MW-170 WAS SAMPLED IN MARCH 2014 AND IS ABANDONED.
9. * INDICATES WELL (MW-234B & MW-600) WAS NOT USED FOR CONTOURING.
10. MW-60, MW-60E AND MW-80 WERE SAMPLED VIA BAILER.
11. PDB = PASSIVE DIFFUSION BAG.
12. PCE = TETRACHLOROETHENE.
13. TCE = TRICHLOROETHENE.
14. c-DCE = CIS-1,2-DICHLOROETHENE.
15. VC = VINYL CHLORIDE.

ENGINEER IN RESPONSIBLE CHARGE OF THE WORK SHOWN ON THIS DRAWING

DATE: _____ SIGNATURE: _____

PROFESSIONAL ENGINEER LIC. # _____

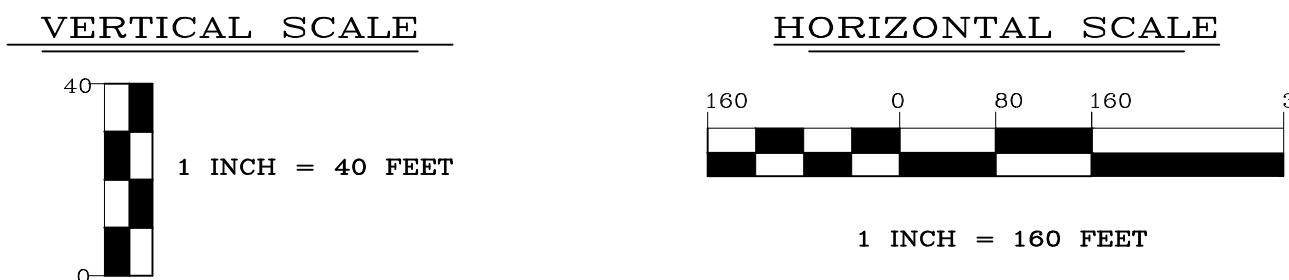

| REV | DATE | BY | DESCRIPTION |
|-----|----------|----|---|
| 1 | 10/01/14 | DS | FINAL ANNUAL REPORT DRAFT ISSUED FOR REVIEW |
| 0 | 06/24/14 | DS | DRAFT ISSUED FOR REVIEW |

| | | | |
|---------------|---------------------------------|-----------|----------|
| DRAWING TITLE | NUTLEY SITE REMEDIATION PROJECT | SCALE | AS SHOWN |
| PROJECT NO. | NR-ST-E-S29215-C1226 | BLDG. NO. | |
| DATE | JUNE 2014 | | |

FILE: C:\Users\jgordon\My Documents\LOCAL\TEMP\PROJECTS\1165\1165231 0000 205 01.XD DATE: 2014-11-20 11:22:46L DATE: 12/15/2014 09:22:14PW