

CROSS-SECTION LOCATION

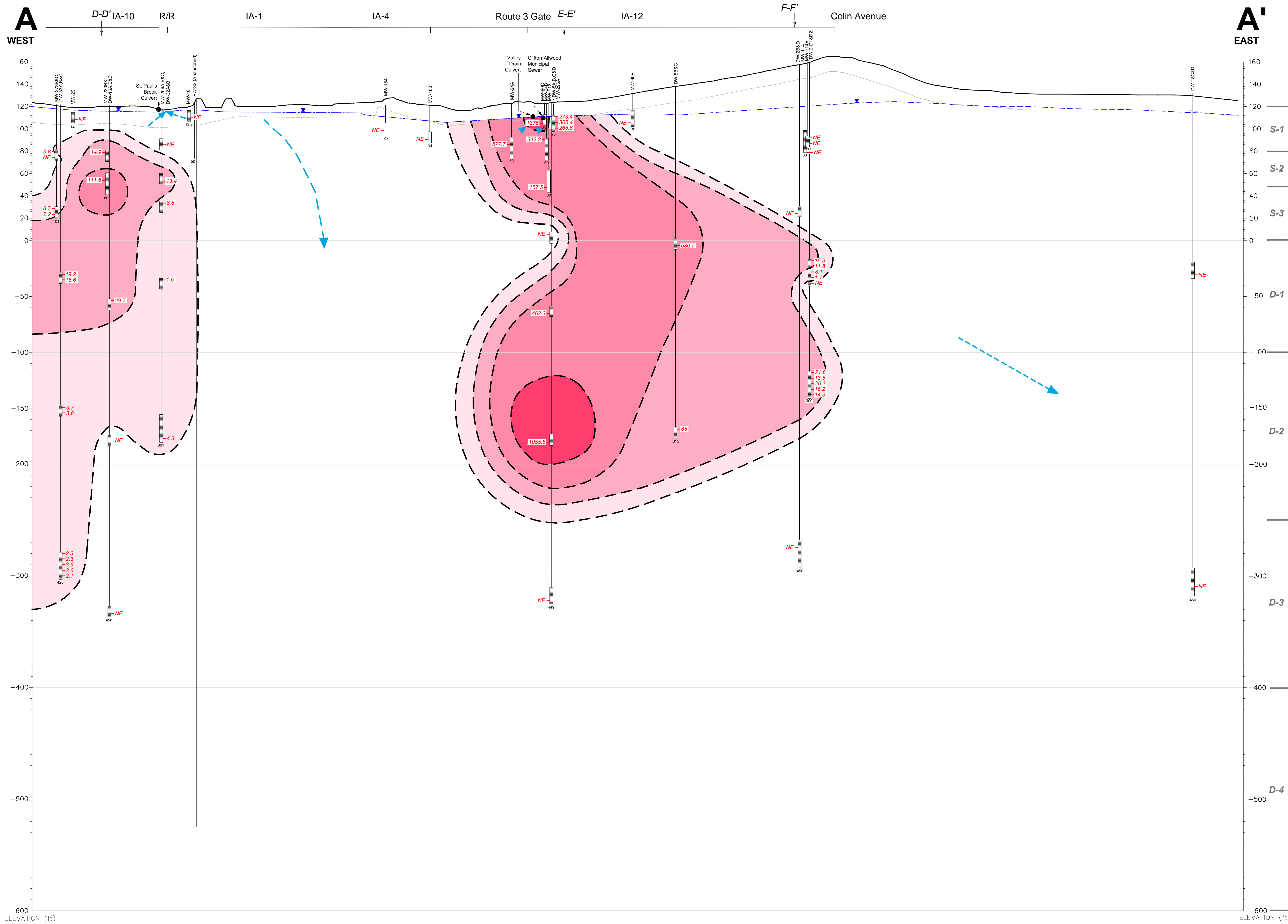

LEGEND

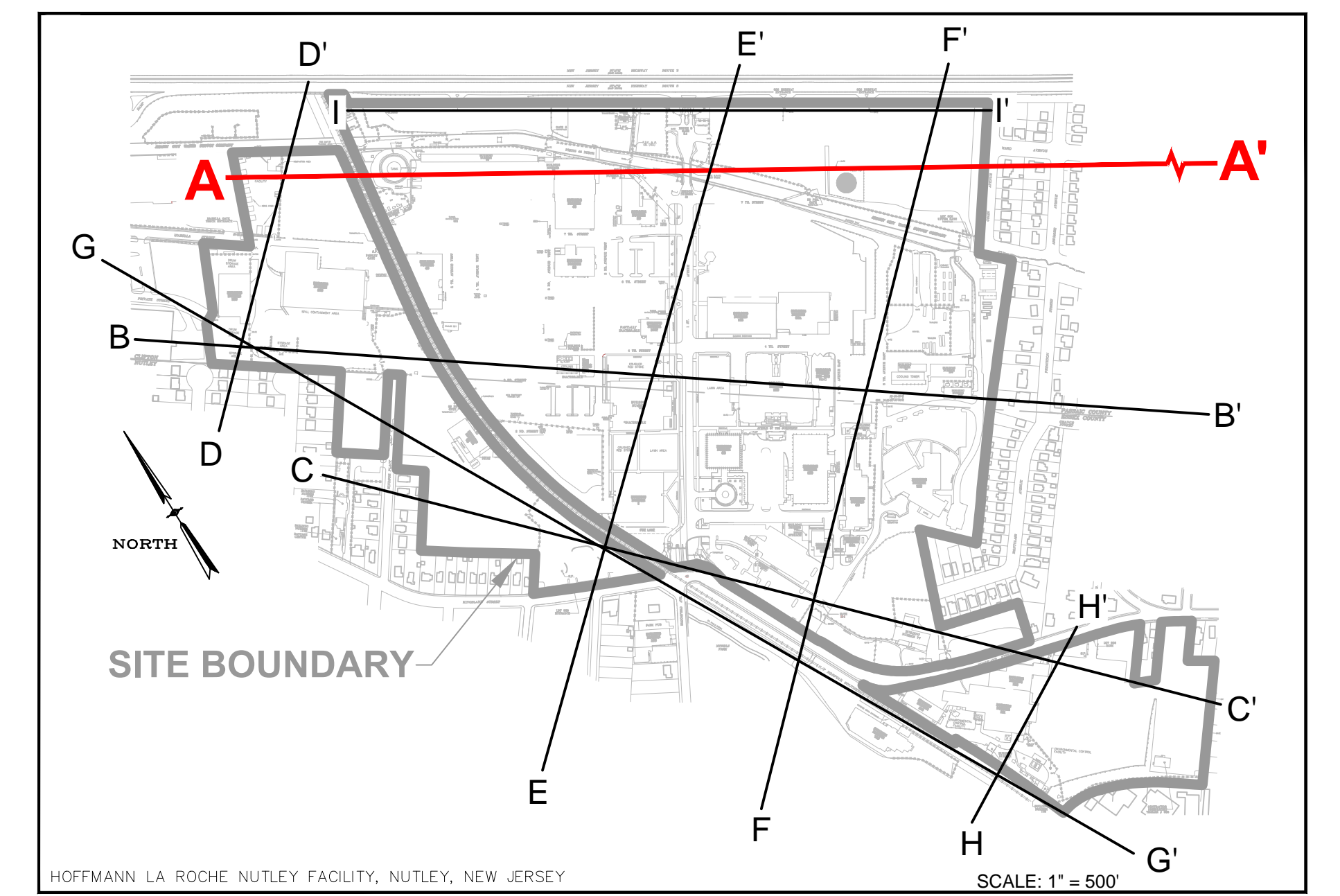
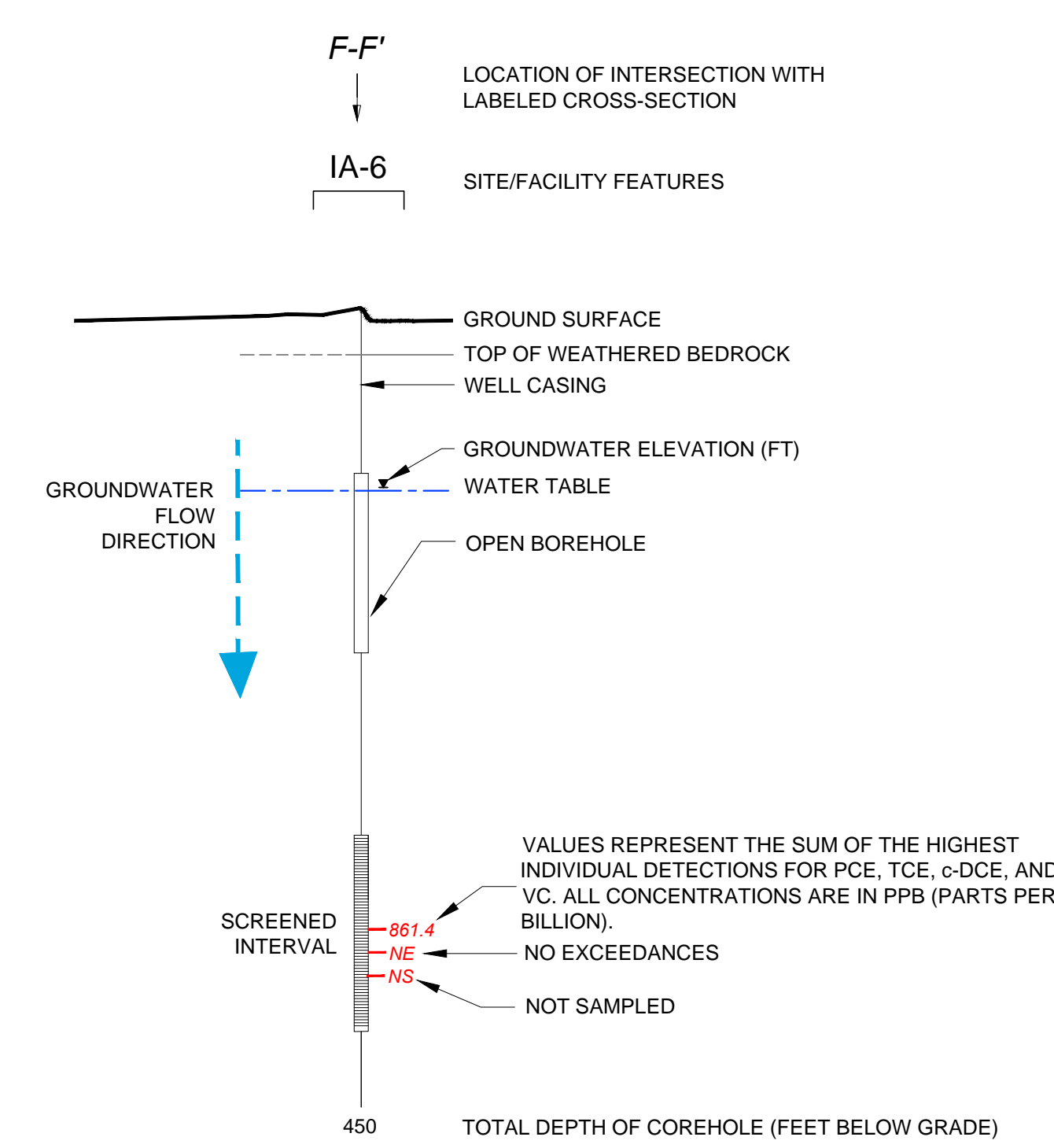

ISOCONCENTRATION CONTOURS OF PCE AND BREAKDOWN PRODUCTS (TCE, C-DCE AND VC) >GWQS*

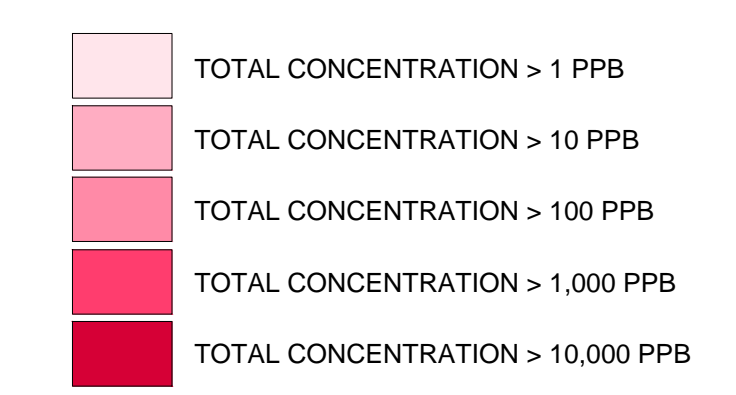

NOTES:

- COREHOLES HAVE BEEN SEALED WITH BLANK FLUTE LINERS.
- GROUND SURFACE IS BASED UPON THE SURFACE ELEVATION ALONG B-B', EXCEPT WEST OF MW-17AW WHERE THE GROUND SURFACE ELEVATION IS BASED UPON SURVEYED GROUND SURFACE AT WELL LOCATIONS.
- SOME WELLS HAVE BEEN PROJECTED UP TO 300 FEET TO CONSTRUCT THIS VERTICAL SECTION AND ARE DISPLAYED AT ACTUAL SURVEYED ELEVATIONS.
- LITHOLOGIC CONTACTS ARE DASHED WHERE INFERRED.
- ELEVATION DATUM NAVD 1988, FEET ABOVE MEAN SEA LEVEL.
- RR = RAILROAD.
- ONLY CVOCs DETECTED ABOVE NJDEP GROUND WATER QUALITY STANDARD (GWQS) ARE INCLUDED IN ISOCONCENTRATION CONTOURS.
- MW-20W WAS SAMPLED VIA LOW-FLOW IN MARCH AND APRIL 2013.
- MW-273B, MW-273C, DW-33A, DW-33B GRAB SAMPLED VIA BAILER.
- PW-37 SHOWN FOR LOCATION PURPOSES ONLY.
- PDB = PASSIVE DIFFUSION BAG.
- PCE = TETRACHLOROETHENE.
- TCE = TRICHLOROETHENE.
- c-DCE = CIS-1,2-DICHLOROETHENE.
- VC = VINYL CHLORIDE.

ENGINEER IN RESPONSIBLE CHARGE OF THE WORK SHOWN ON THIS DRAWING
 DATE: _____ SIGNATURE: _____
 PROFESSIONAL ENGINEER: _____ LIC. # _____

TRC
 TRC ENVIRONMENTAL CORP.
 41 SPRING STREET
 NEW PROVIDENCE, NEW JERSEY 07974
 908-988-1700

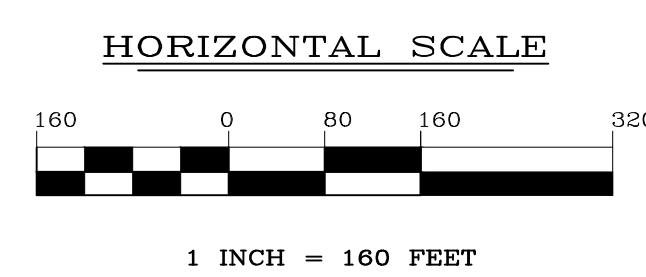
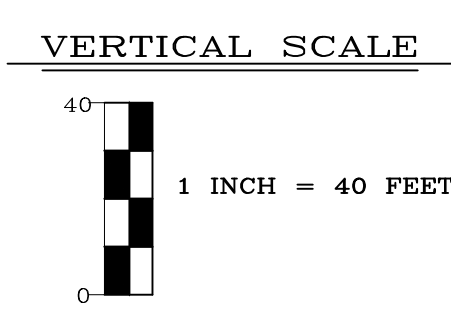

REV	DATE	BY	DESCRIPTION
1	10/01/14	DS	FINAL ANNUAL REPORT DRAFT ISSUED FOR REVIEW
0	04/24/14	DS	DRAFT ISSUED FOR REVIEW

DRAWING TITLE: NUTLEY SITE REMEDIATION PROJECT
 PROJECT TITLE: FIGURE 77 CVDC DISTRIBUTION IN GROUNDWATER CROSS-SECTION A-A' JUNE 2014 SAMPLING EVENT
 SCALE: AS SHOWN
 BLDG. NO.:
 PREPARED FOR: Hoffmann-La Roche Inc. 340 KINGSLAND STREET NUTLEY, NEW JERSEY 07110-1199
 DRAWING NO.: NR-STE-S29215-C1223

FILE: \\WJL001\FP21\DRAWING\FILES\VISION PROJECTS\15500\016 WDC GROUND WATER REPORT FIGURES\ANNUAL REPORT\02 2014\A-SEC. DATE: 12/10/2014 09:15:20PM