

CROSS-SECTION LOCATION

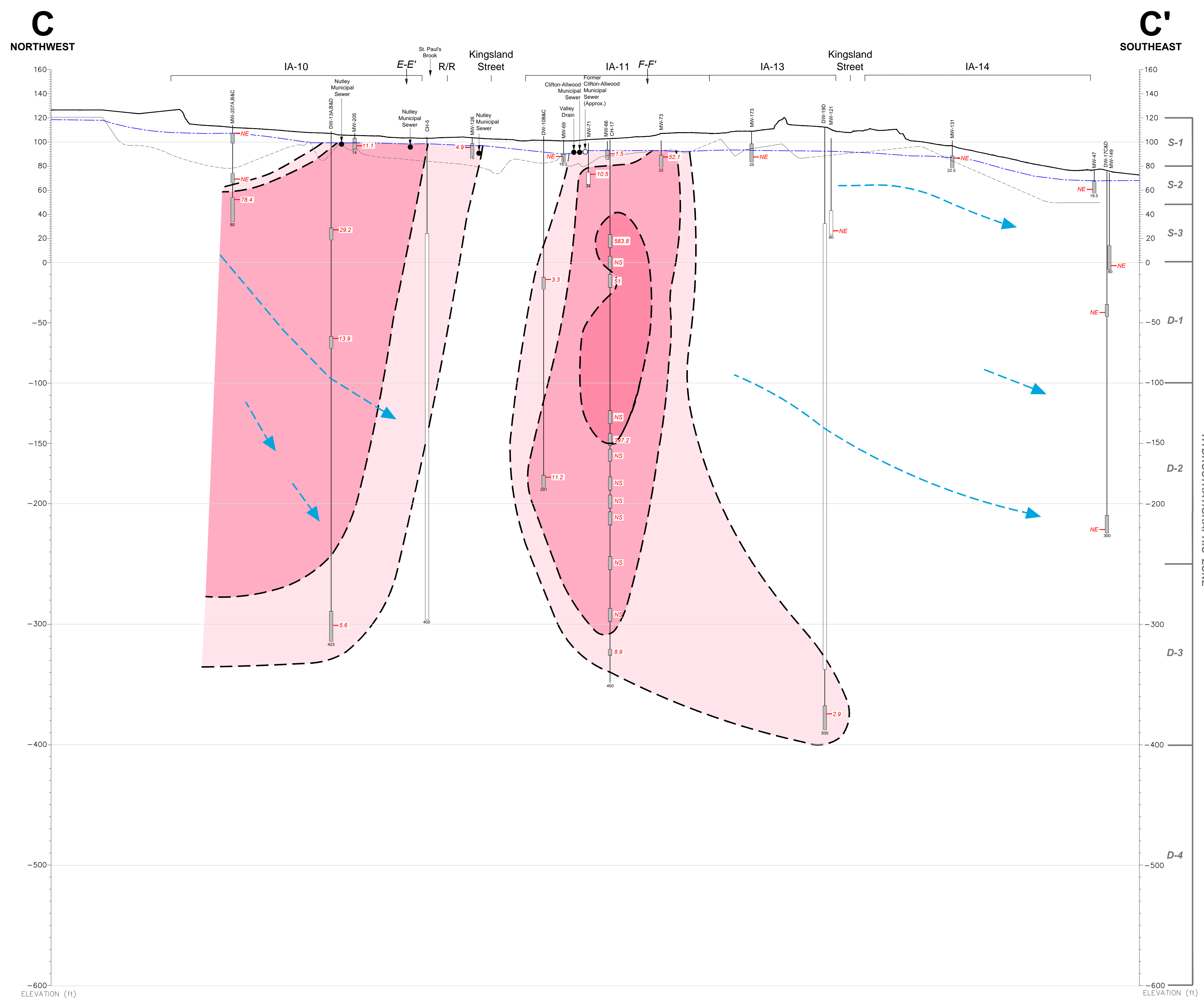

LEGEND

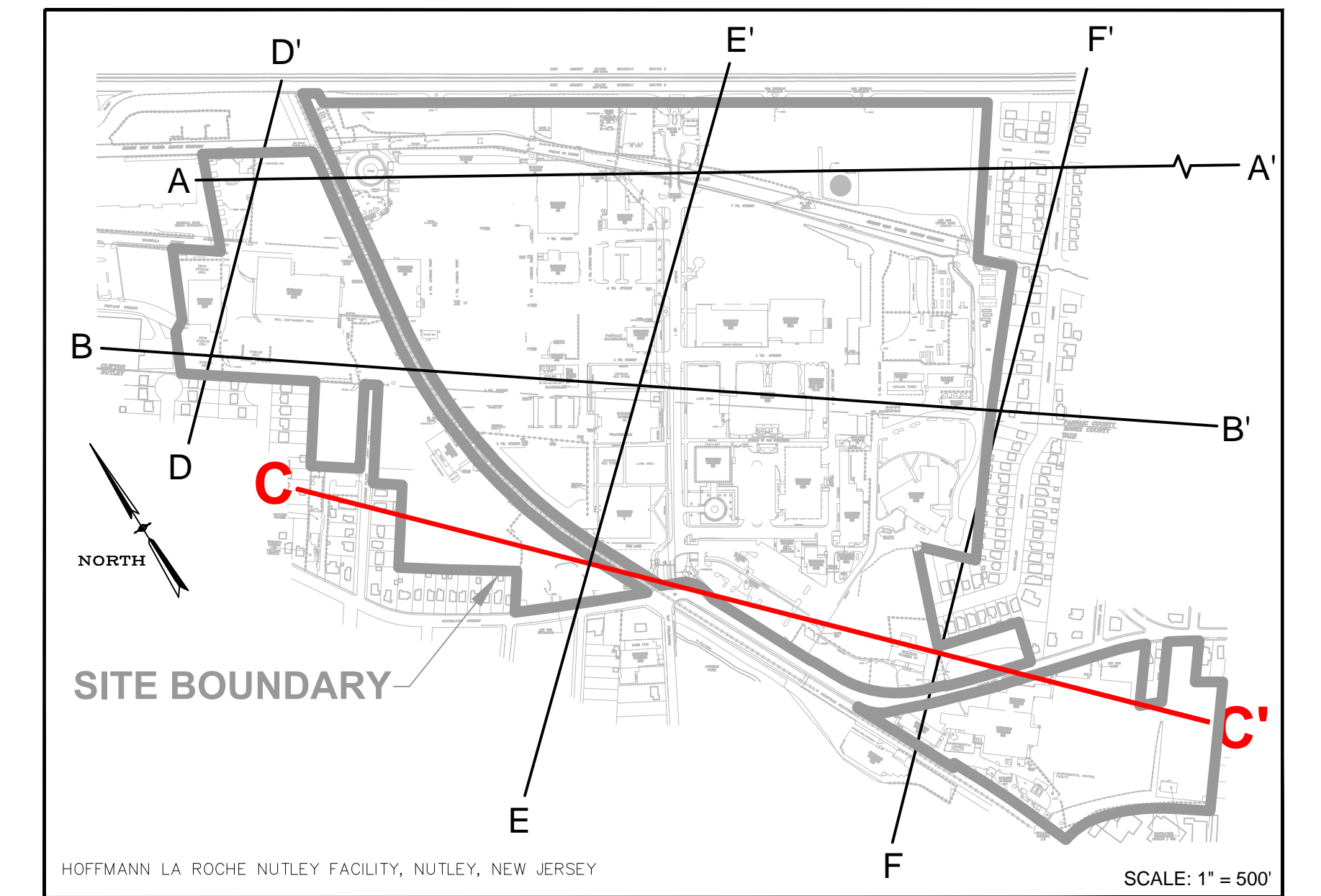
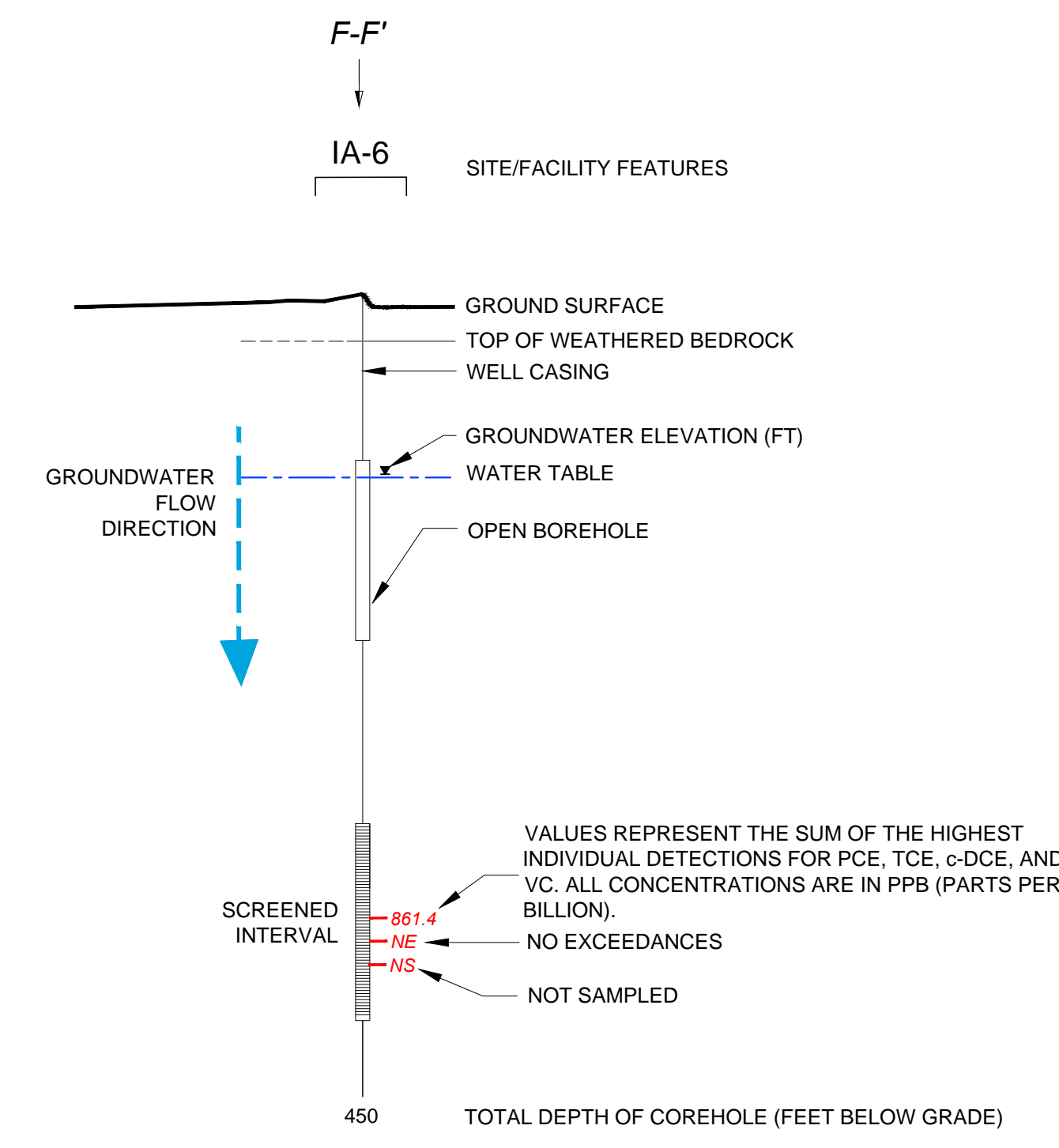

ISOCONCENTRATION CONTOURS OF PCE AND BREAKDOWN PRODUCTS (TCE, C-DCE AND VC) >GWQS*

- TOTAL CONCENTRATION > 1 PPB
 - TOTAL CONCENTRATION > 10 PPB
 - TOTAL CONCENTRATION > 100 PPB
 - TOTAL CONCENTRATION > 1,000 PPB
 - TOTAL CONCENTRATION > 10,000 PPB
- * SEE NOTE #7

NOTES:

1. COREHOLES HAVE BEEN SEALED WITH BLANK FLUTE LINERS.
2. GROUND SURFACE IS BASED UPON THE SURFACE ELEVATION ALONG C-C'.
3. SOME WELLS HAVE BEEN PROJECTED UP TO 300 FEET TO CONSTRUCT THIS VERTICAL SECTION AND ARE DISPLAYED AT ACTUAL SURVEYED ELEVATIONS.
4. LITHOLOGIC CONTACTS ARE DASHED WHERE INFERRED.
5. ELEVATION DATUM NAVD 1988; FEET ABOVE MEAN SEA LEVEL.
6. R/R = RAILROAD.
7. ONLY CVOCs DETECTED ABOVE NJDEP GROUND WATER QUALITY STANDARD (GWQS) ARE INCLUDED IN ISOCONCENTRATION CONTOURS.
8. CH-17 WAS SAMPLED VIA LOW-FLOW.
9. PDB = PASSIVE DIFFUSION BAG.
10. PCE = TETRACHLOROETHENE.
11. TCE = TRICHLOROETHENE.
12. c-DCE = CIS-1,2-DICHLOROETHENE.
13. VC = VINYL CHLORIDE.

ENGINEER IN RESPONSIBLE CHARGE OF THE WORK SHOWN ON THIS DRAWING

DATE: _____ SIGNATURE: _____

PROFESSIONAL ENGINEER: _____ LIC. # _____

TRC

TRC ENVIRONMENTAL CORP.
41 SPRING STREET
NEW PROVIDENCE, NEW JERSEY 07974
908-988-1700

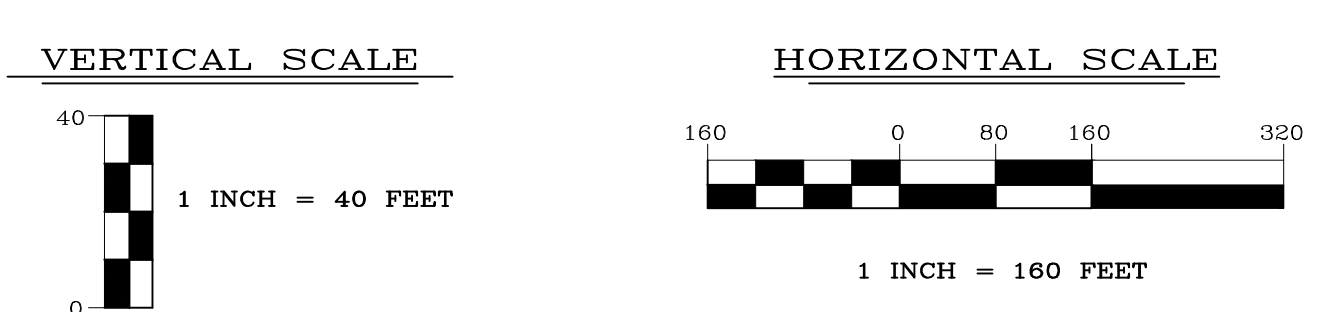

REV	DATE	BY	DESCRIPTION
1	10/21/14	DS	FINAL ANNUAL REPORT DRAFT ISSUED FOR REVIEW
0	03/05/14	DS	DRAFT ISSUED FOR REVIEW

DRAWING TITLE	NUTLEY SITE REMEDIATION PROJECT	PROJECT NUMBER	GCIERP1AL
DESIGN SUPERVISOR	T. O'MEARA	PROJECT ENGINEER	G. CIERPIAL
DATE	1/26/14	SCALE	AS SHOWN
PROJECT	ROCHE	CLIENT	Hoffmann-La Roche Inc.
PROJECT ADDRESS	340 KINGSLAND STREET	CITY	NUTLEY, NEW JERSEY 07110-1199
DRAWING NO.	NR-STE-S29215-C1043	SCALE	AS SHOWN

FILE: C:\Users\jgordon\My Documents\LOCAL\TEMP\PROJECTS\2165\192531 0000 205 01 00 DDC PLIMS 2014 10206.dwg DATE: 12/10/2014 09:27:07 AM