

CROSS-SECTION LOCATION

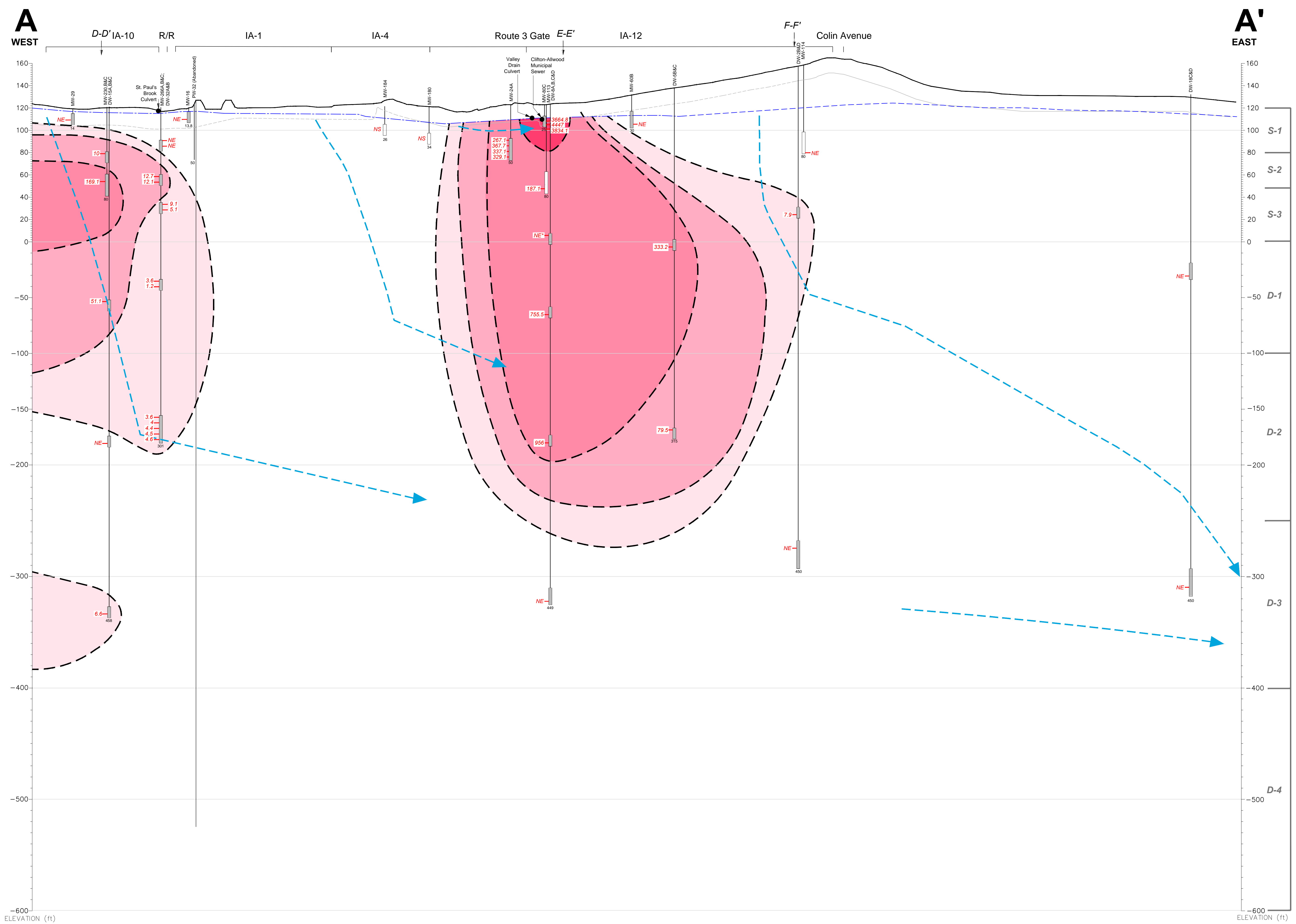

LEGEND

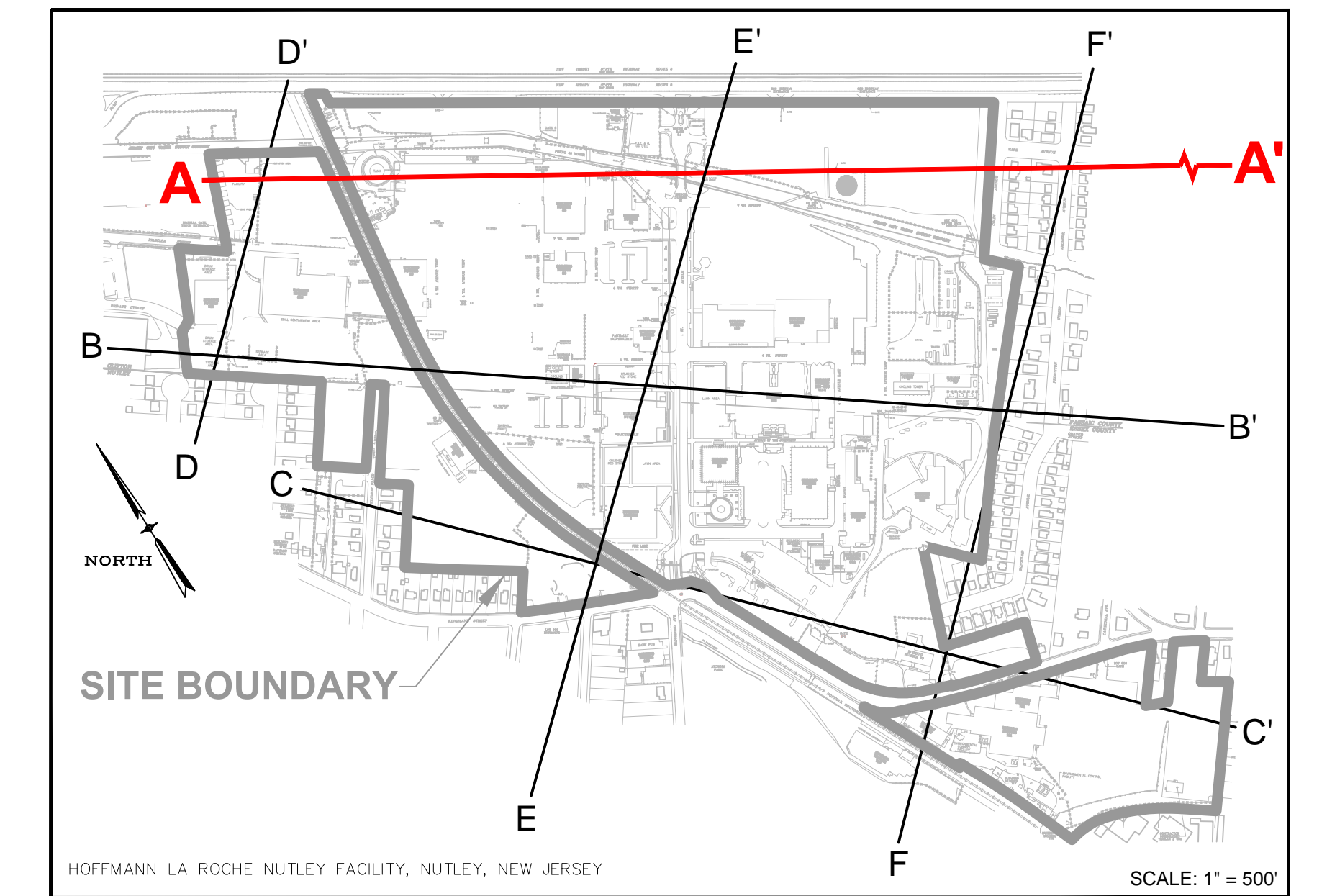
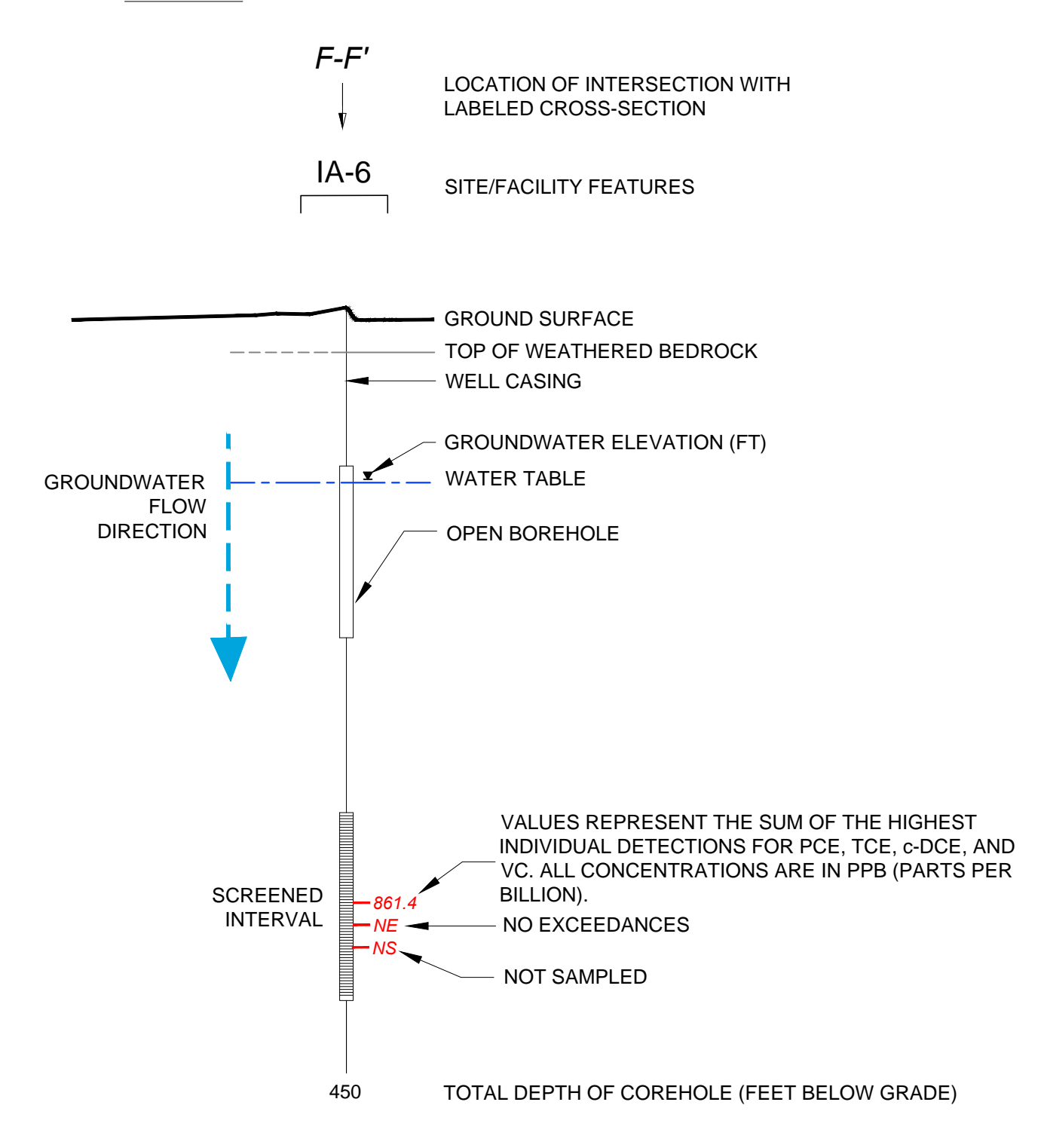

ISOCONCENTRATION CONTOURS OF PCE AND BREAKDOWN PRODUCTS (TCE, C-DCE AND VC) >GWQS\*

- TOTAL CONCENTRATION > 1 PPB
- TOTAL CONCENTRATION > 10 PPB
- TOTAL CONCENTRATION > 100 PPB
- TOTAL CONCENTRATION > 1,000 PPB
- TOTAL CONCENTRATION > 10,000 PPB

NOTES:

1. COREHOLES HAVE BEEN SEALED WITH BLANK FLUTE LINERS.
2. GROUND SURFACE IS BASED UPON THE SURFACE ELEVATION ALONG A-A'.
3. SOME WELLS HAVE BEEN PROJECTED UP TO 300 FEET TO CONSTRUCT THIS VERTICAL SECTION AND ARE DISPLAYED AT ACTUAL SURVEYED ELEVATIONS.
4. LITHOLOGIC CONTACTS ARE DASHED WHERE INFERRED.
5. ELEVATION DATUM NAVD 1988; FEET ABOVE MEAN SEA LEVEL.
6. R/R = RAILROAD.
7. ONLY CVQCS DETECTED ABOVE NJDEP GROUND WATER QUALITY STANDARD (GWQS) ARE INCLUDED IN ISOCONCENTRATION CONTOURS.
8. PDB = PASSIVE DIFFUSION BAG.
9. PCE = TETRACHLOROETHENE.
10. TCE = TRICHLOROETHENE.
11. C-DCE = CIS-1,2-DICHLOROETHENE.
12. VC = VINYL CHLORIDE.

ENGINEER IN RESPONSIBLE CHARGE OF THE WORK SHOWN ON THIS DRAWING

DATE: \_\_\_\_\_ SIGNATURE: \_\_\_\_\_

PROFESSIONAL ENGINEER LIC. # \_\_\_\_\_

**TRC**

TRC ENVIRONMENTAL CORP.  
41 SPRING STREET  
NEW PROVIDENCE, NEW JERSEY 07974  
908-988-1700

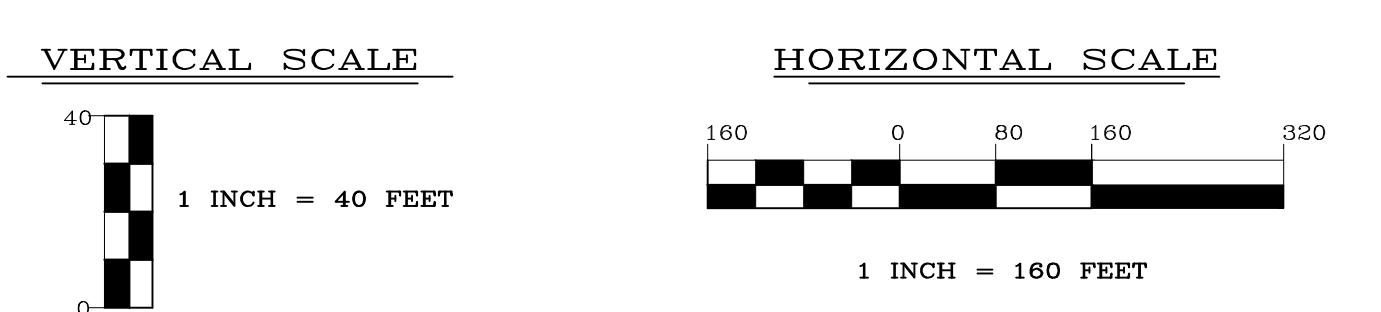

REV	DATE	BY	DESCRIPTION
1	10/01/14	DS	FINAL ANNUAL REPORT DRAFT ISSUED FOR REVIEW
0	03/05/14	DS	DRAFT ISSUED FOR REVIEW

DRAWING TITLE NUTLEY SITE REMEDIATION PROJECT		PROJECT TITLE FIGURE 72 CVQC DISTRIBUTION IN GROUNDWATER CROSS-SECTION A-A' MARCH 2014 SAMPLING EVENT		SCALE AS SHOWN BLDG. NO.
DESIGNED BY T.Q. MEARA	DRAWN BY D. STEHLE	CHECKED BY S. MCCRAY	PROJECT ENGINEER G. CIERPIAL	PREPARED FOR <b>Roche</b> Hoffmann-La Roche Inc. 340 KINGSLAND STREET NUTLEY, NEW JERSEY 07110-1199
DESIGN SUPERVISOR PROJECT ENGINEER			DRAWING NO. NR-STE-S29215-C1041	

FILE: C:\USERS\GREGOR\APPDATA\LOCAL\TEMP\FOLDER\_3165\196233\_0000\_205\_01\_00\_DRAWING\_PLMES\_2014\_10\_28.DWG, DATE: 12/10/2014 09:26:10PM