

CROSS-SECTION LOCATION

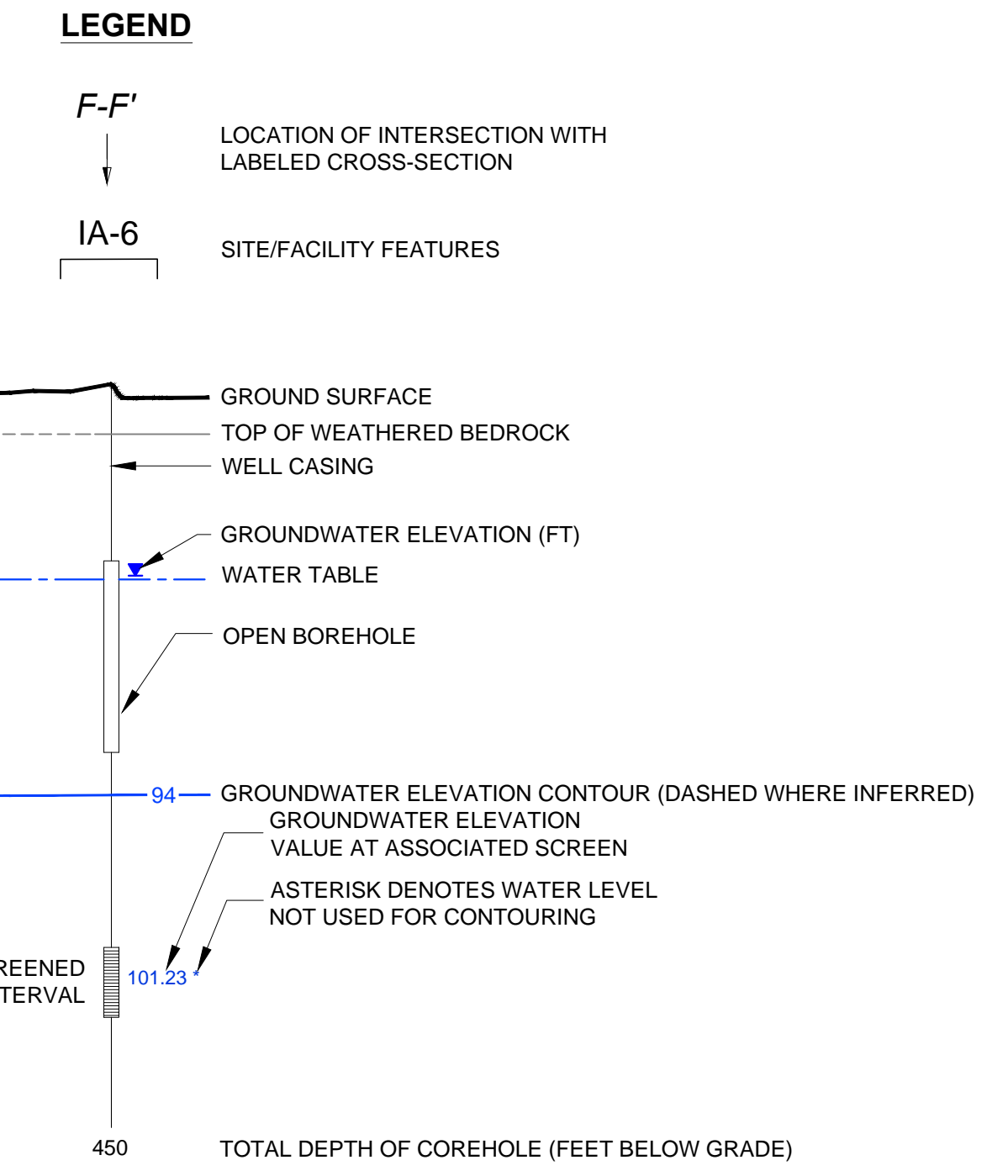
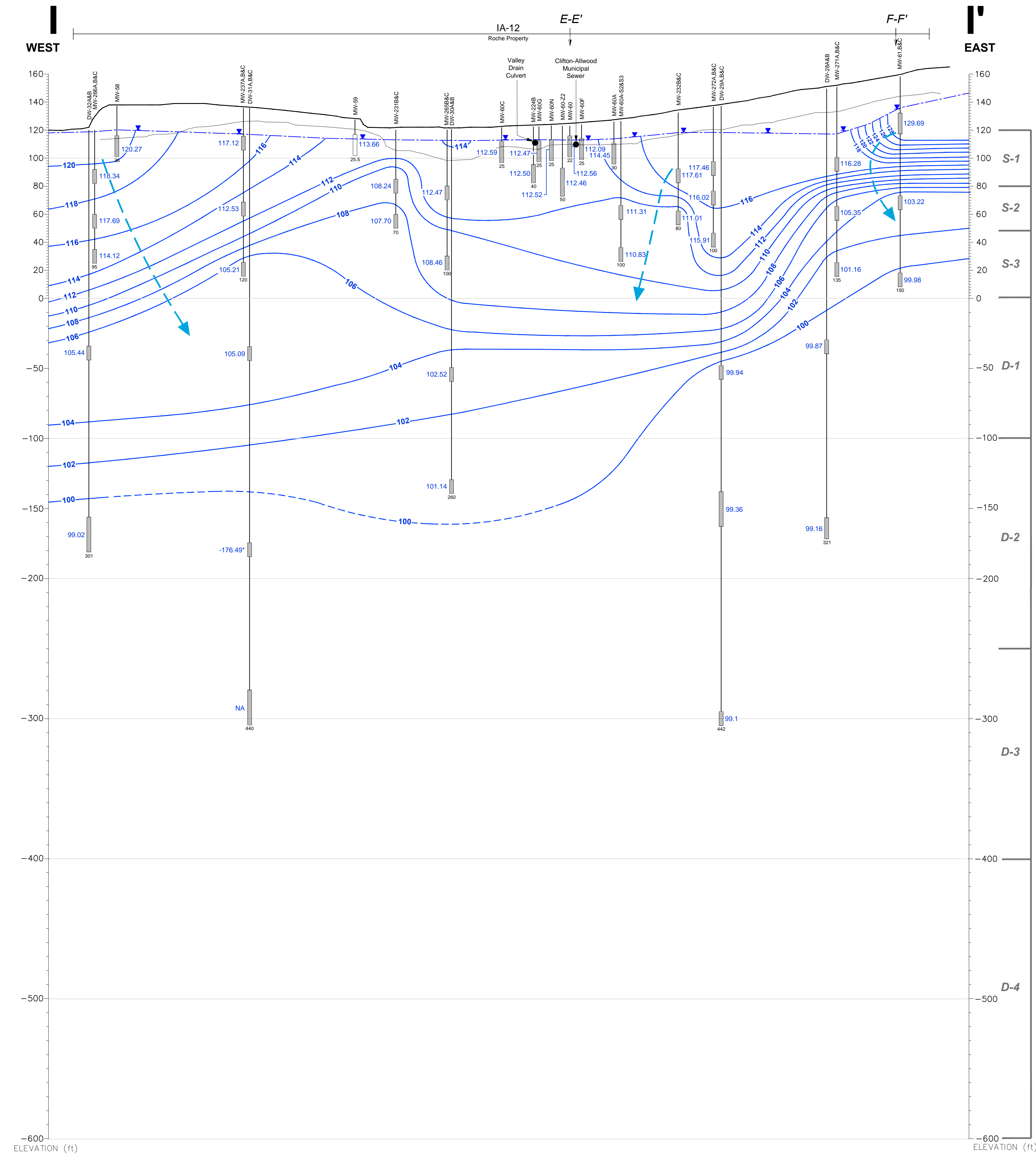
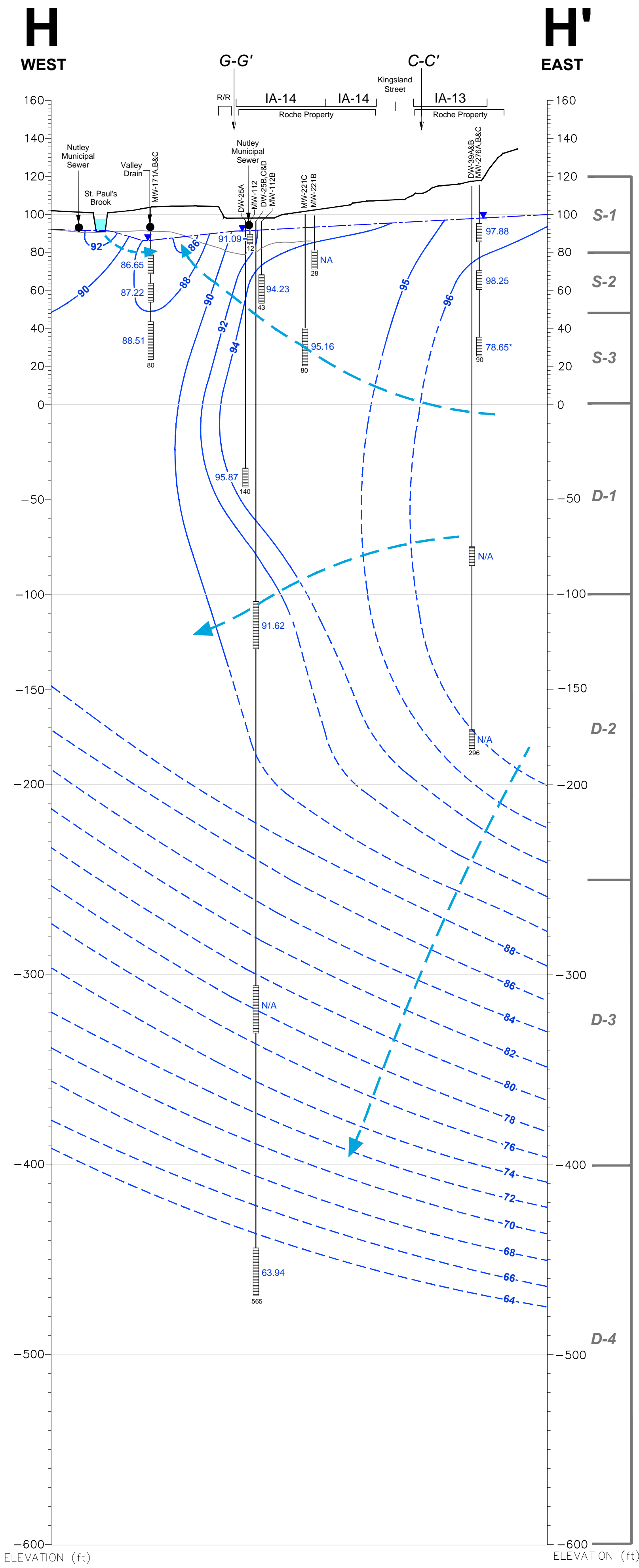
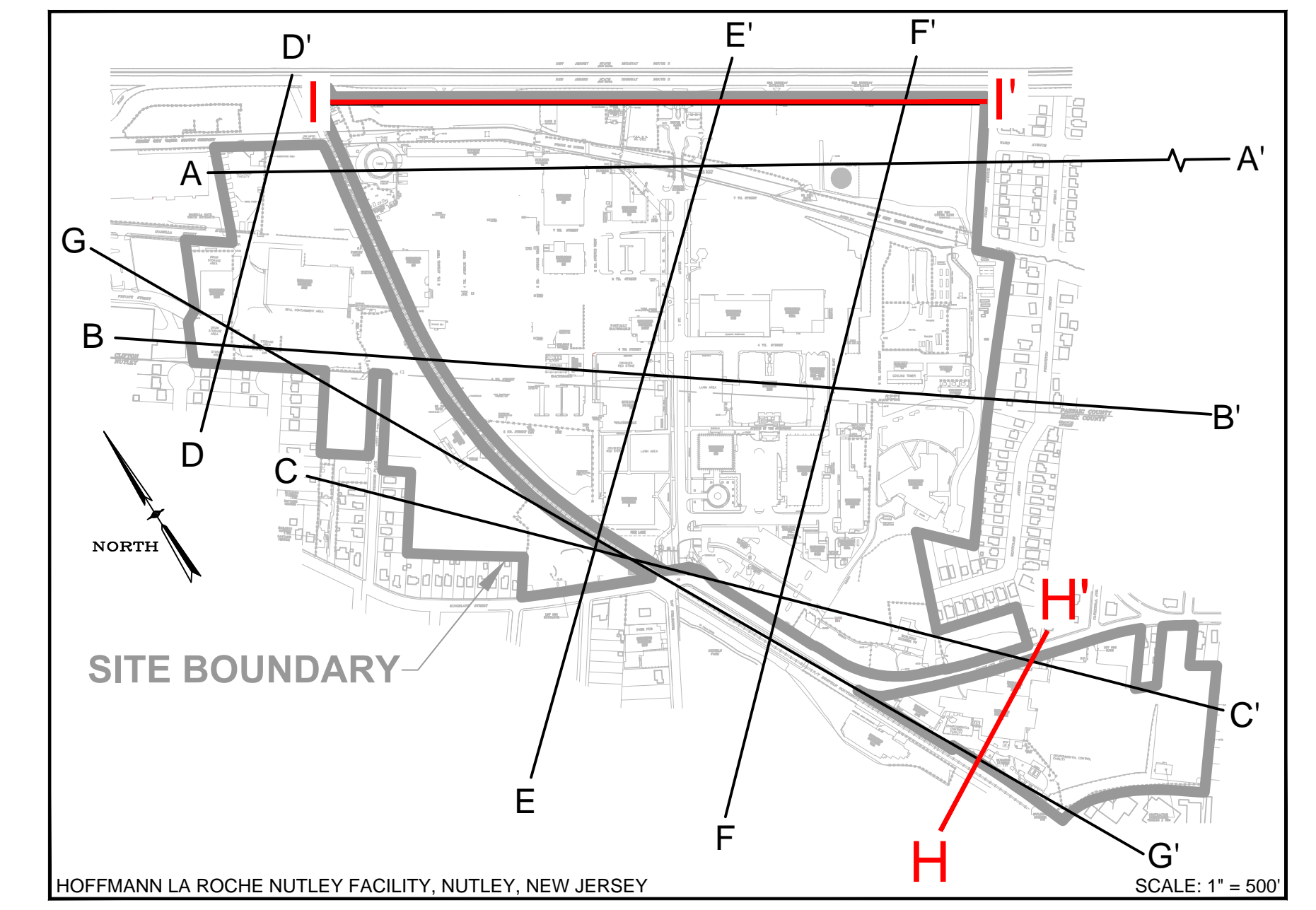

- NOTES:**
- GROUND SURFACE IS BASED UPON THE SURFACE ELEVATION ALONG H-H AND I-I.
  - SOME WELLS HAVE BEEN PROJECTED UP TO 300 FEET TO CONSTRUCT THIS VERTICAL SECTION AND ARE DISPLAYED AT ACTUAL SURVEYED ELEVATIONS.
  - LITHOLOGIC CONTACTS ARE DASHED WHERE INFERRED.
  - ELEVATION DATUM NAVD 1988; FEET ABOVE MEAN SEA LEVEL.
  - R/R = RAILROAD.
  - NA = GROUNDWATER ELEVATION NOT AVAILABLE.

ENGINEER IN RESPONSIBLE CHARGE OF THE WORK SHOWN ON THIS DRAWING

DATE: \_\_\_\_\_ SIGNATURE: \_\_\_\_\_

PROFESSIONAL LIC. # \_\_\_\_\_

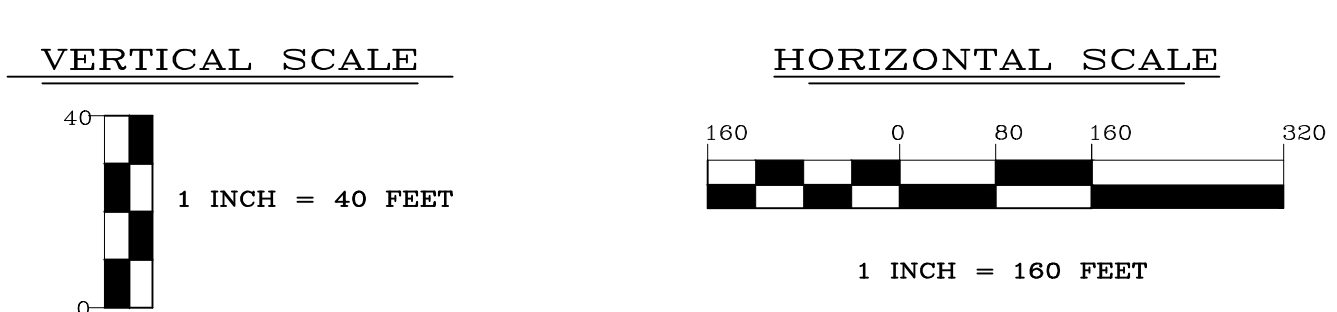

REV	DATE	BY	DESCRIPTION
1	09/30/14	DS	FINAL ANNUAL REPORT DRAFT ISSUED FOR REVIEW
0	06/21/14	DS	DRAFT ISSUED FOR REVIEW

DRAWING TITLE NUTLEY SITE REMEDIATION PROJECT		PROJECT TITLE FIGURE 45 VERTICAL GROUNDWATER FLOW CROSS-SECTION H-H' & I-I' MEASURED 06-02-14		SCALE AS SHOWN BLDG. NO.
DESIGNED BY T.O'MEARA	DRAWN BY D.STEHLER	CHECKED BY S.MCCRAY	PROJECT ENGINEER G.CIERPIAL	PREPARED FOR Hoffmann-La Roche Inc. 340 KINGSLAND STREET NUTLEY, NEW JERSEY 07110-1199
DESIGN SUPERVISOR PROJECT ENGINEER			DRAWING NO. NR-STE-S29215-C1254	