

CROSS-SECTION LOCATION

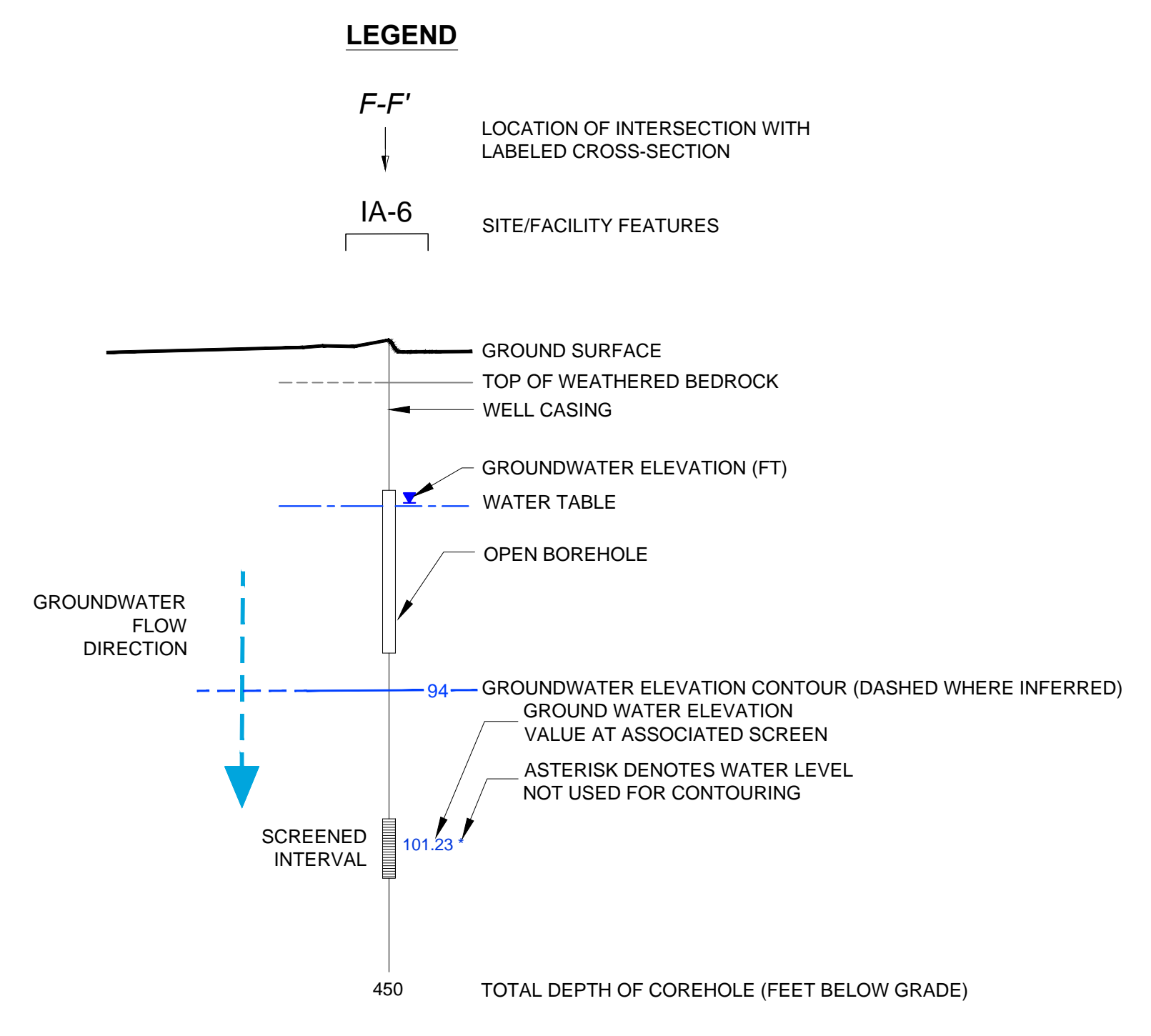

- NOTES:**
- COREHOLES ARE SEALED WITH BLANK FLUTE LINERS EXCEPT PW-37 WHICH HAS A MULTILEVEL FLUTE.
  - GROUND SURFACE IS BASED UPON THE SURFACE ELEVATION ALONG G-G'.
  - WELLS HAVE BEEN PROJECTED UP TO 300 FEET TO CONSTRUCT THIS SECTION AND DISPLAYED AT ACTUAL SURVEYED ELEVATIONS.
  - CONTACTS ARE DASHED WHERE INFERRED.
  - ELEVATION DATUM NAVD 1988, FEET ABOVE MEAN SEA LEVEL.
  - R/R = RAILROAD
  - N/A = GROUNDWATER ELEVATION NOT AVAILABLE.

ENGINEER IN RESPONSIBLE CHARGE OF THE WORK SHOWN ON THIS DRAWING  
 DATE: \_\_\_\_\_ SIGNATURE: \_\_\_\_\_  
 PROFESSIONAL ENGINEER LIC. # \_\_\_\_\_

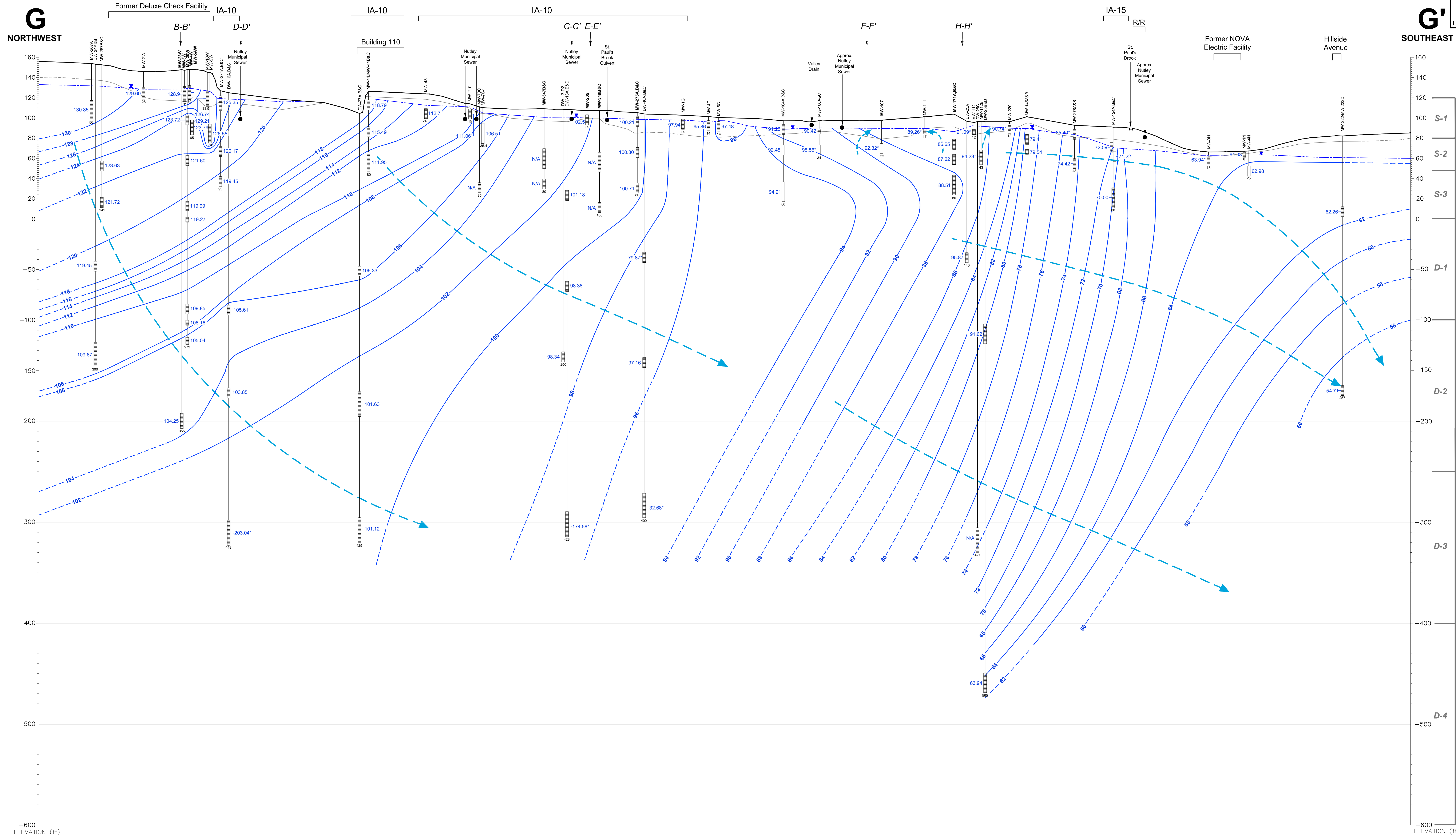
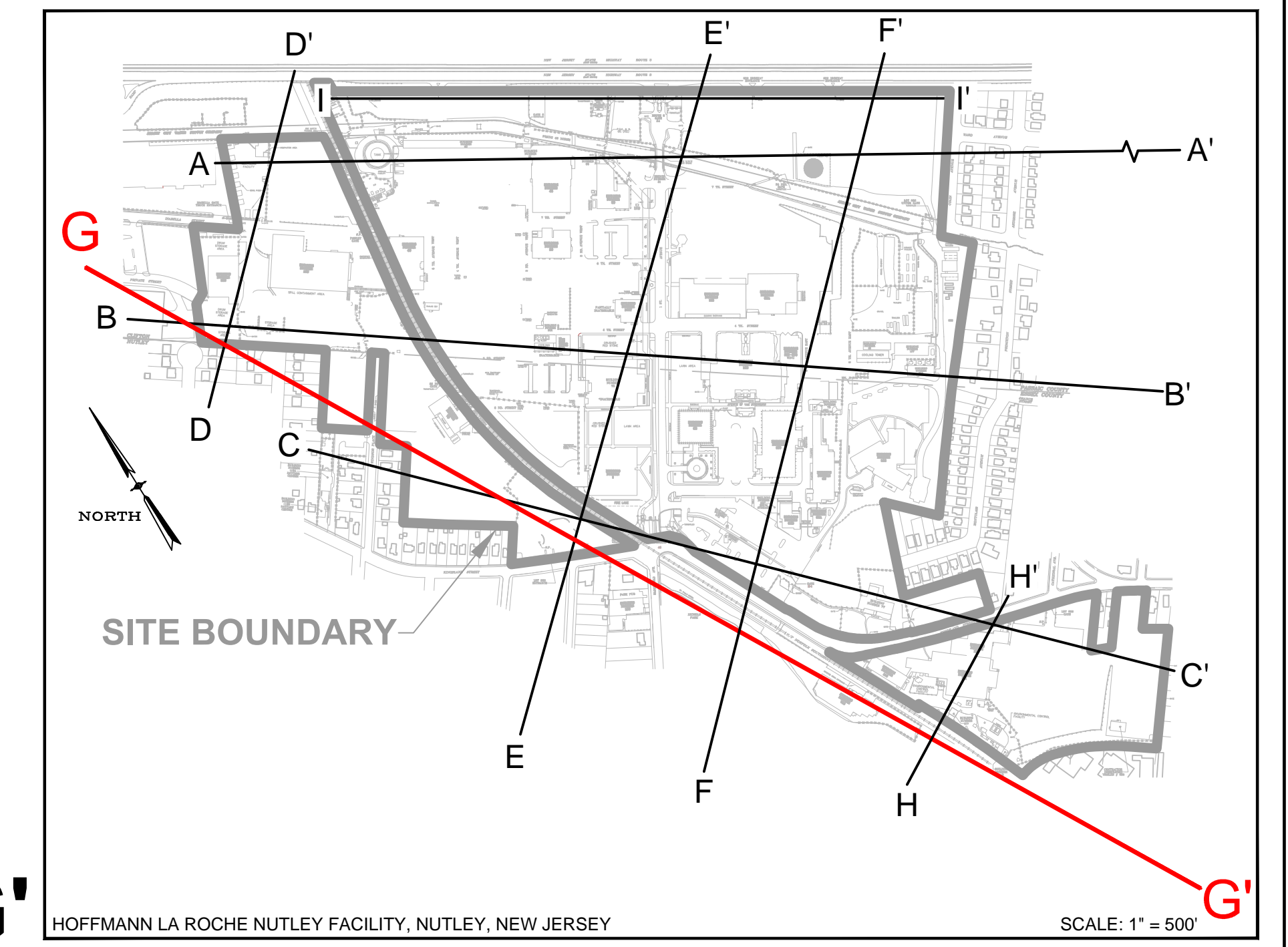
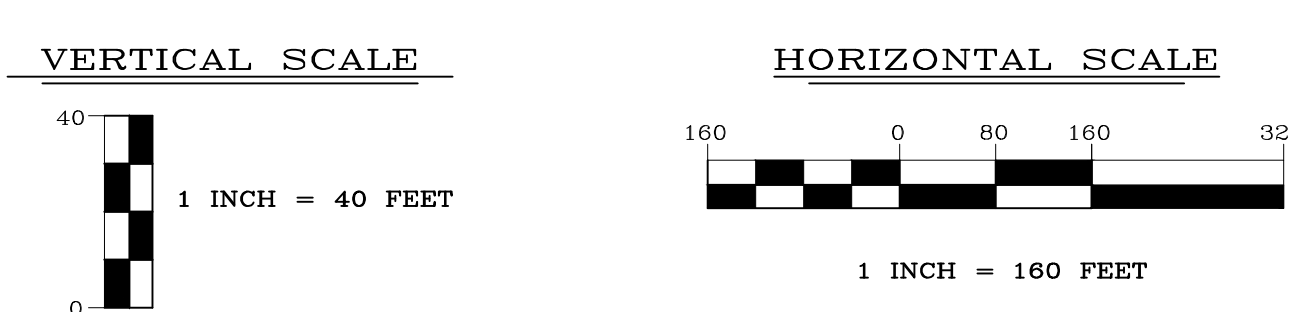

REV	DATE	BY	DESCRIPTION
1	09/30/14	DS	FINAL ANNUAL REPORT DRAFT ISSUED FOR REVIEW
0	06/21/14	DS	DRAFT ISSUED FOR REVIEW

DRAWING TITLE NUTLEY SITE REMEDIATION PROJECT		PROJECT TITLE FIGURE 44 VERTICAL GROUNDWATER FLOW CROSS-SECTION G-G' MEASURED 06-02-14		SCALE AS SHOWN BLDG. NO.
DESIGNED BY T. D'IMEARA	CHECKED BY D. STEHLE	DRAWN BY S. MCCRAY	PROJECT NUMBER GCIERPIAL	PREPARED FOR Hoffmann-La Roche Inc. 340 KINGSLAND STREET NUTLEY, NEW JERSEY 07110-1199
DESIGN SUPERVISOR PROJECT ENGINEER		DRAWING NO. NR-STE-S29215-C1214		