

CROSS-SECTION LOCATION

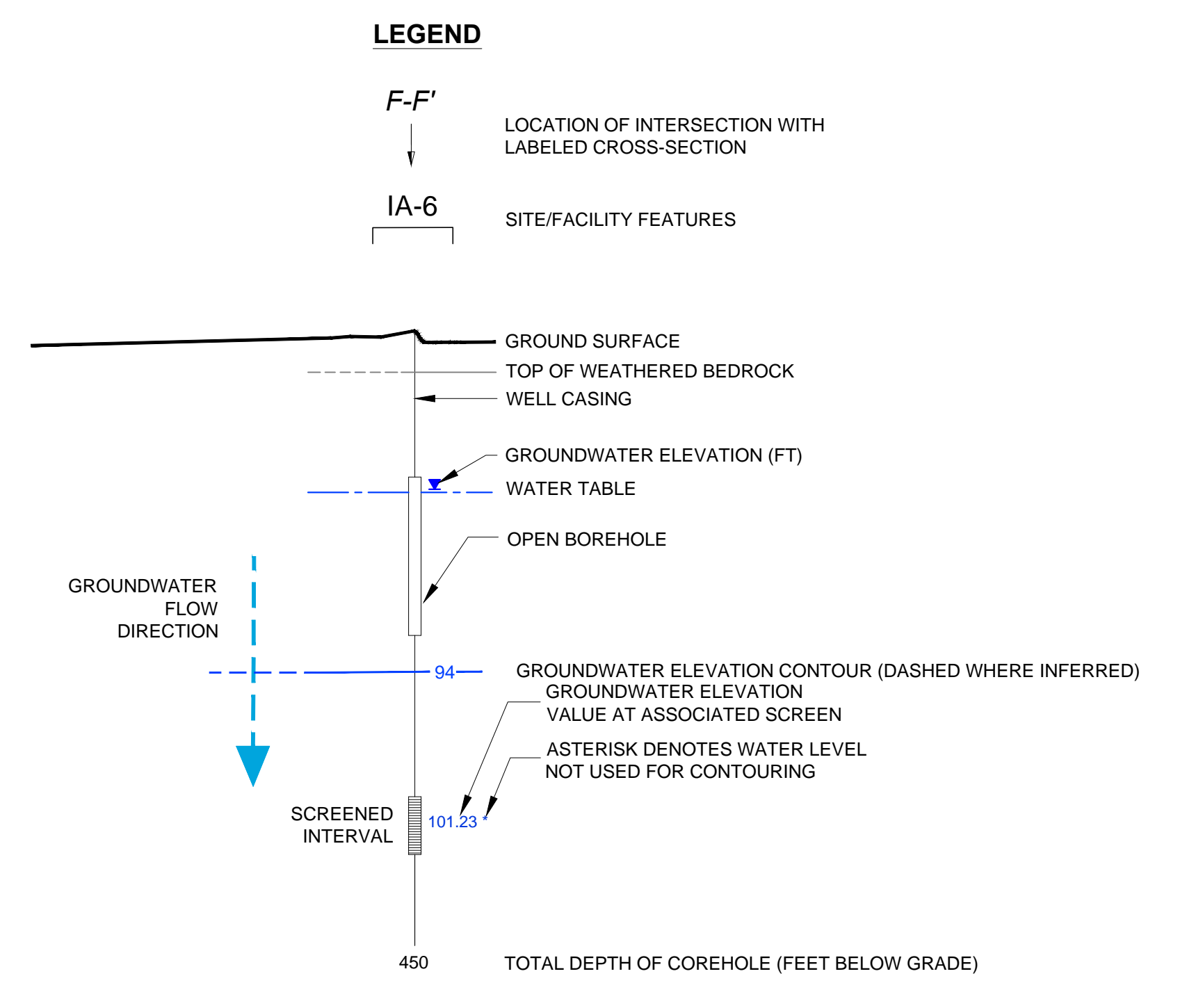
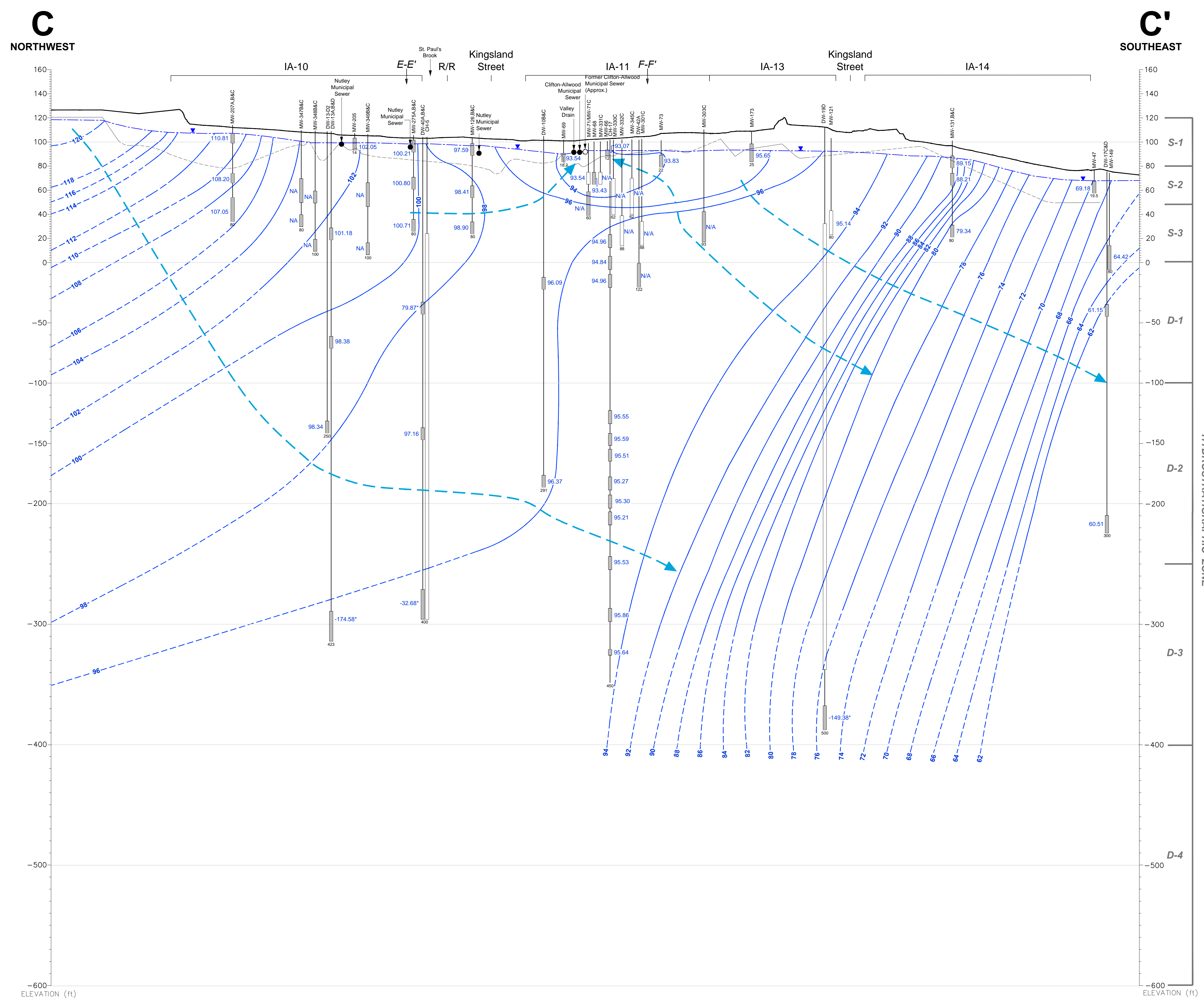
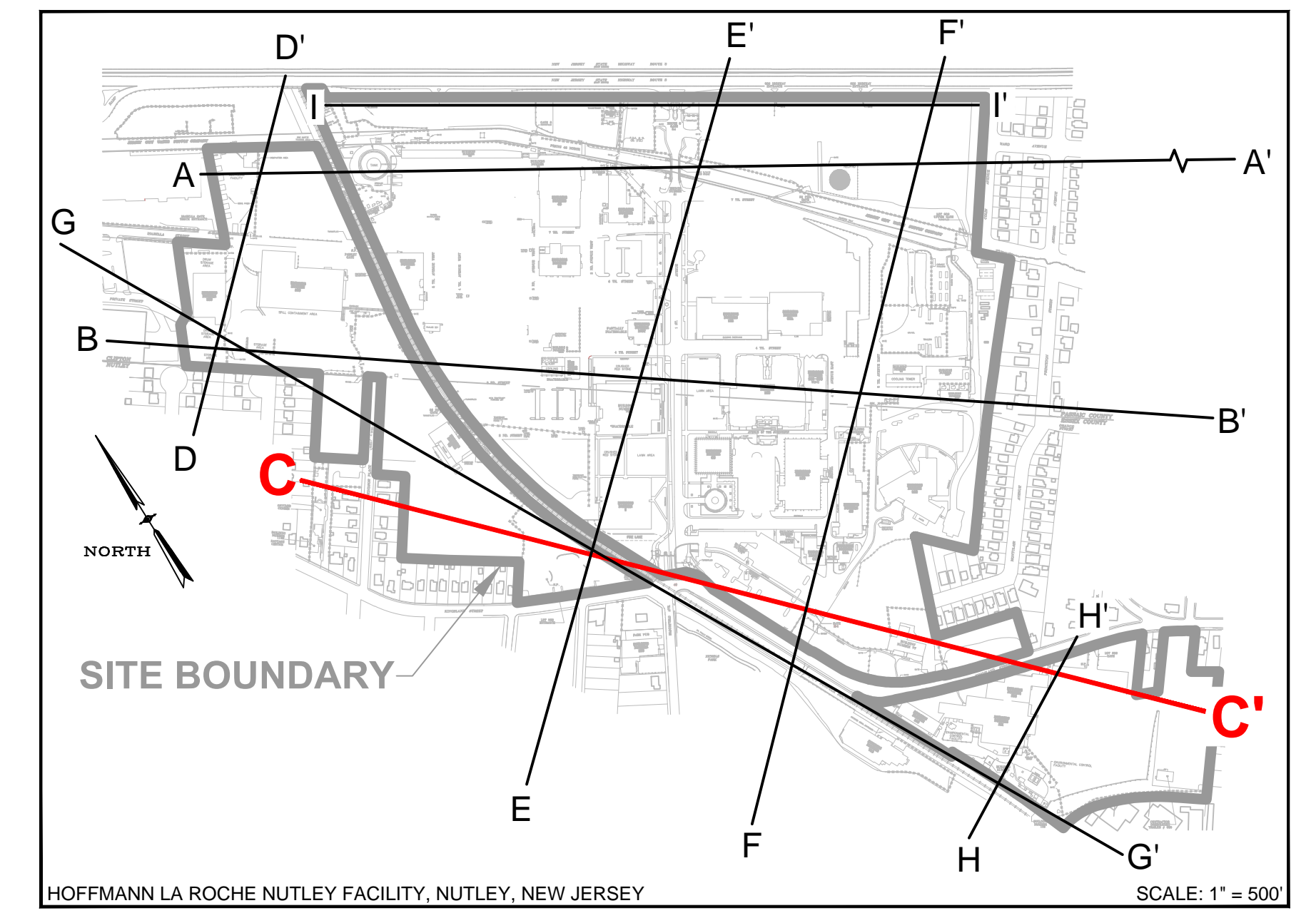

- NOTES:**
- GROUND SURFACE IS BASED UPON THE SURFACE ELEVATION ALONG C-C'.
 - COREHOLES ARE SEALED WITH BLANK FLUTE LINERS EXCEPT CH-17 WHICH HAS A MULTI-LEVEL.
 - SOME WELLS HAVE BEEN PROJECTED UP TO 300 FEET TO CONSTRUCT THIS VERTICAL SECTION AND ARE DISPLAYED AT ACTUAL SURVEYED ELEVATIONS.
 - LITHOLOGIC CONTACTS ARE DASHED WHERE INFERRED.
 - ELEVATION DATUM NAVD 1988; FEET ABOVE MEAN SEA LEVEL.
 - R/R = RAILROAD.
 - N/A = GROUNDWATER ELEVATION NOT AVAILABLE.

ENGINEER IN RESPONSIBLE CHARGE OF THE WORK SHOWN ON THIS DRAWING

DATE: _____ SIGNATURE: _____

PROFESSIONAL ENGINEER LIC. # _____

TRC

TRC ENVIRONMENTAL CORP.
41 SPRING STREET
NEW PROVIDENCE, NEW JERSEY 07974
908-988-1700

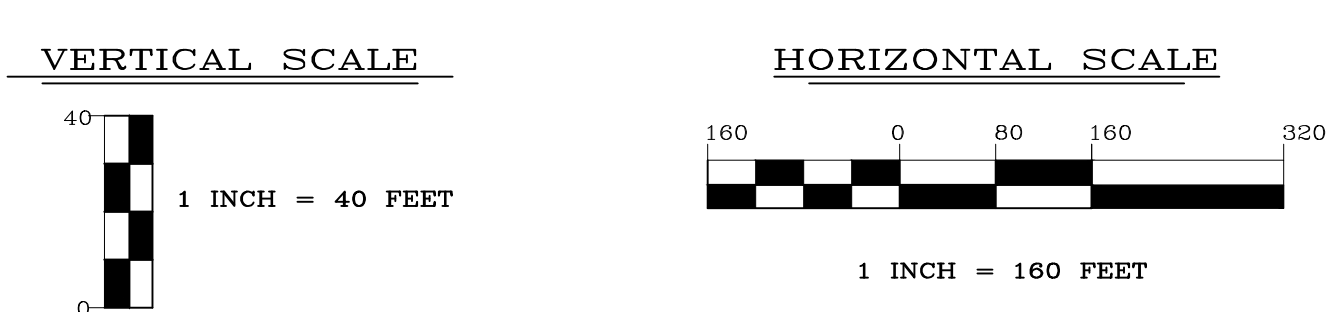

REV	DATE	BY	DESCRIPTION
1	09/30/14	DS	FINAL ANNUAL REPORT DRAFT ISSUED FOR REVIEW
0	06/24/14	DS	DRAFT ISSUED FOR REVIEW

DRAWING TITLE	NUTLEY SITE REMEDIATION PROJECT	PROJECT TITLE	FIGURE 41 VERTICAL GROUNDWATER FLOW CROSS-SECTION C-C' MEASURED 06-02-14	SCALE	AS SHOWN
DATE	06/24/14	DESIGNED BY	J. MCGRAY	PROJECT NUMBER	
DRAWN BY	T. O'NEARA	CHECKED BY	J. MCGRAY	PREPARED FOR	Hoffmann-La Roche Inc.
PROJECT ENGINEER		APPROVED BY	J. MCGRAY	ADDRESS	340 KINGSLAND STREET NUTLEY, NEW JERSEY 07110-1199
				DRAWING NO.	NR-STE-S29215-C1211