

CROSS-SECTION LOCATION

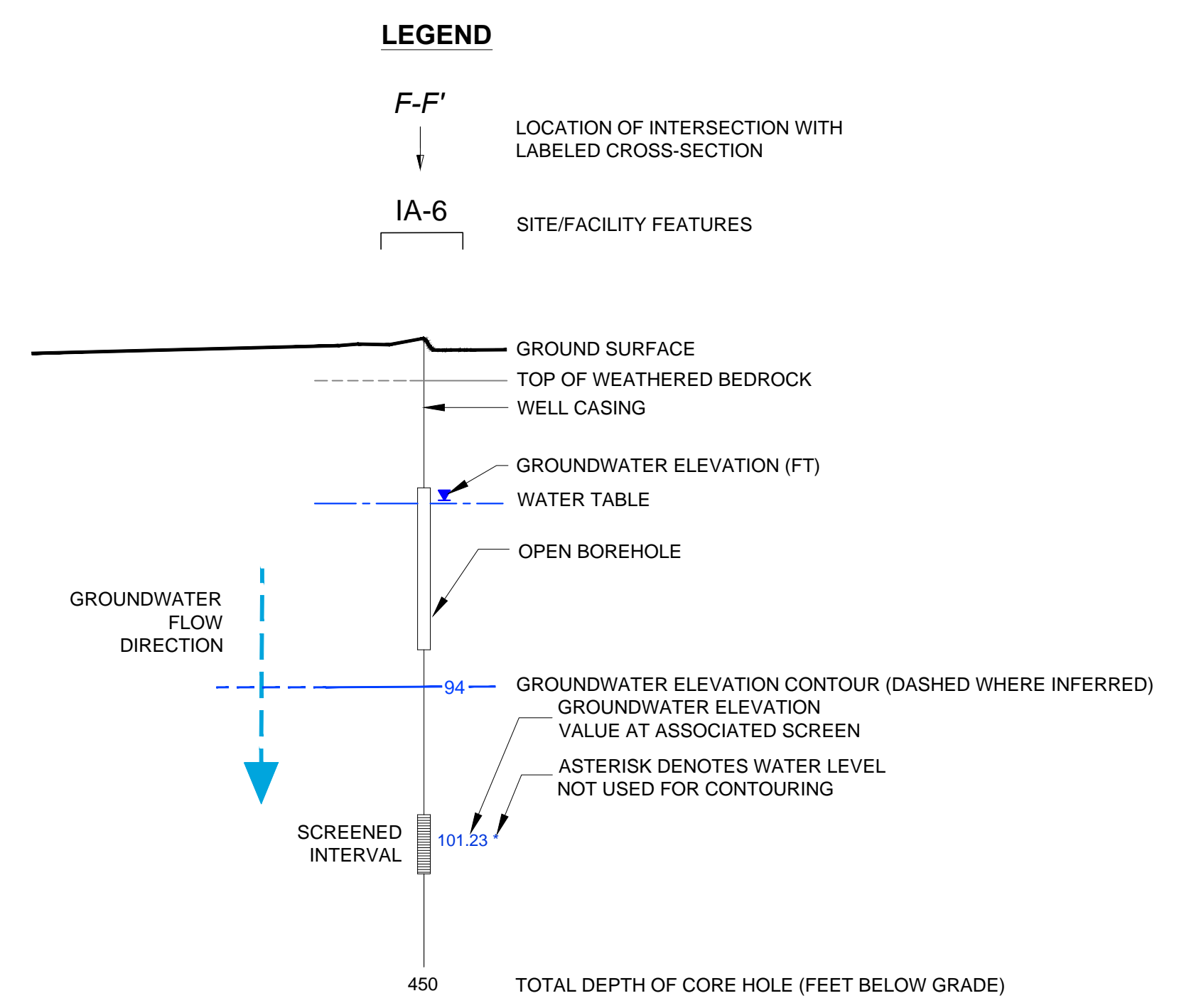
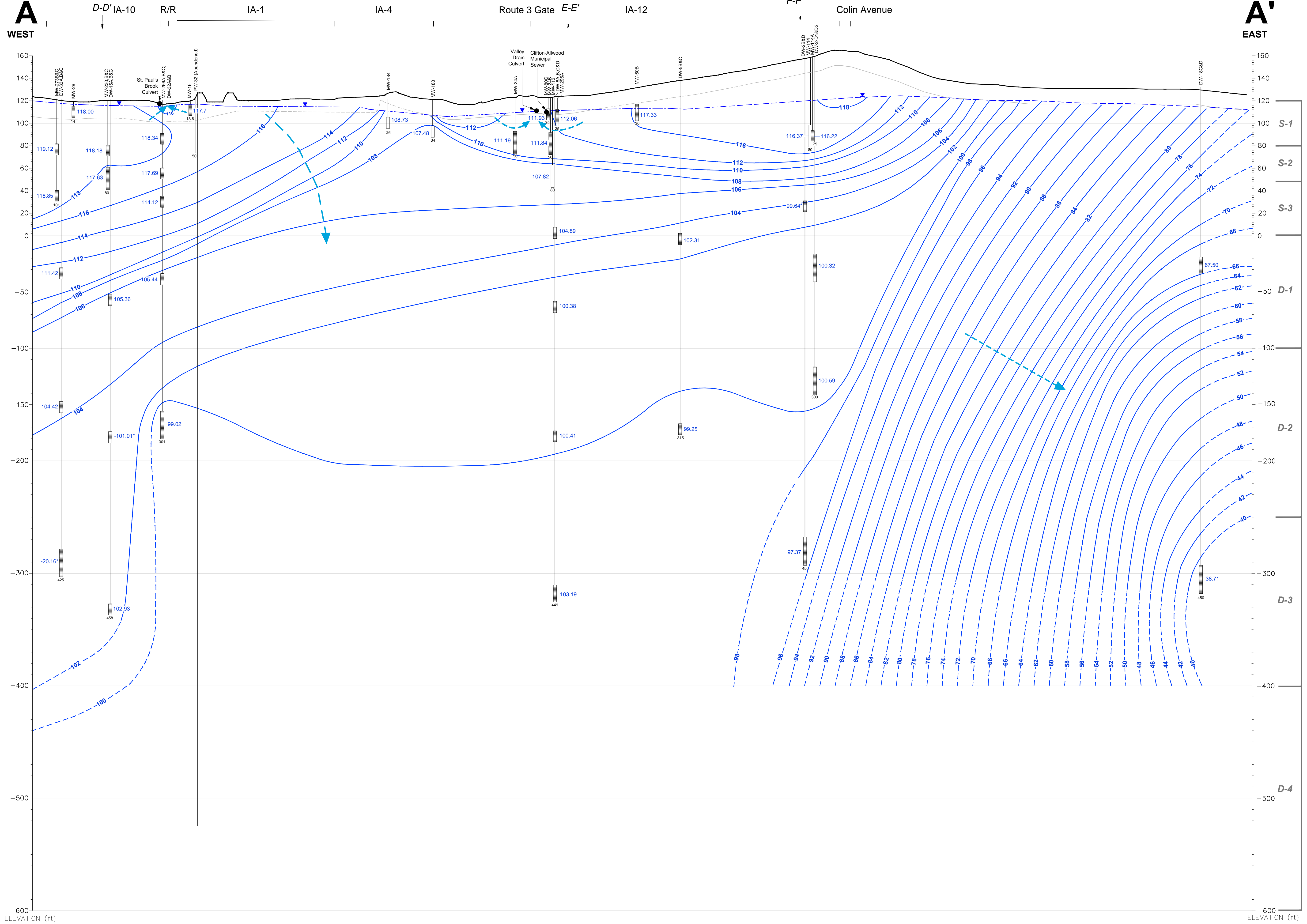
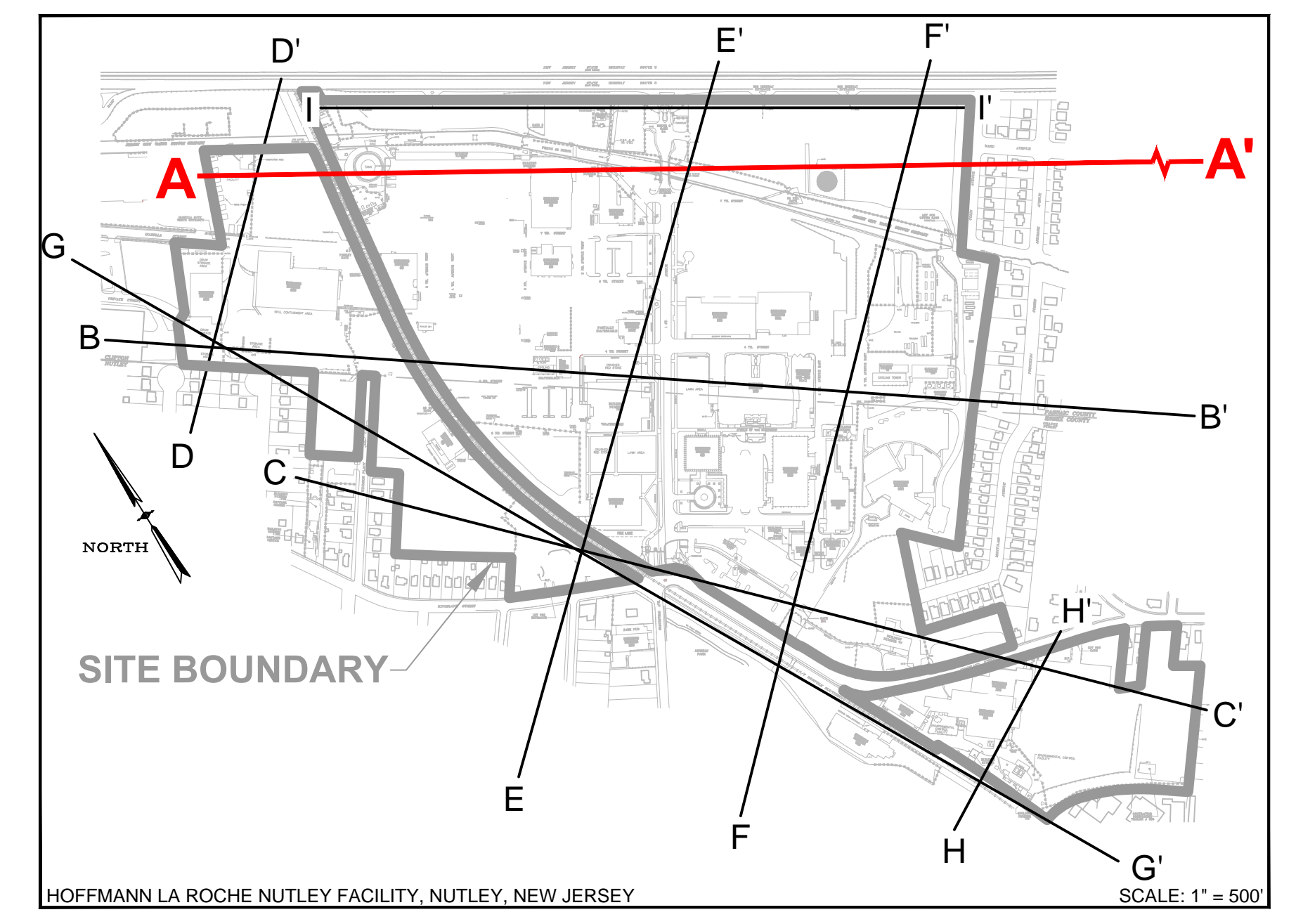

- NOTES:
1. COREHOLES HAVE BEEN SEALED WITH BLANK FLUTE LINERS.
2. GROUND SURFACE IS BASED UPON THE SURFACE ELEVATION ALONG A-A'.
3. SOME WELLS HAVE BEEN PROJECTED UP TO 300 FEET TO CONSTRUCT THIS VERTICAL SECTION AND ARE DISPLAYED AT ACTUAL SURVEYED ELEVATIONS.
4. LITHOLOGIC CONTACTS ARE DASHED WHERE INFERRED.
5. ELEVATION DATUM NAVD 1988; FEET ABOVE MEAN SEA LEVEL.
6. R/R = RAILROAD.

ENGINEER IN RESPONSIBLE CHARGE OF THE WORK SHOWN ON THIS DRAWING
DATE:
SIGNATURE:
PROFESSIONAL ENGINEER LIC. #

TRC ENVIRONMENTAL CORP.
41 SPRING STREET
NEW PROVIDENCE, NEW JERSEY 07974
908-988-1700

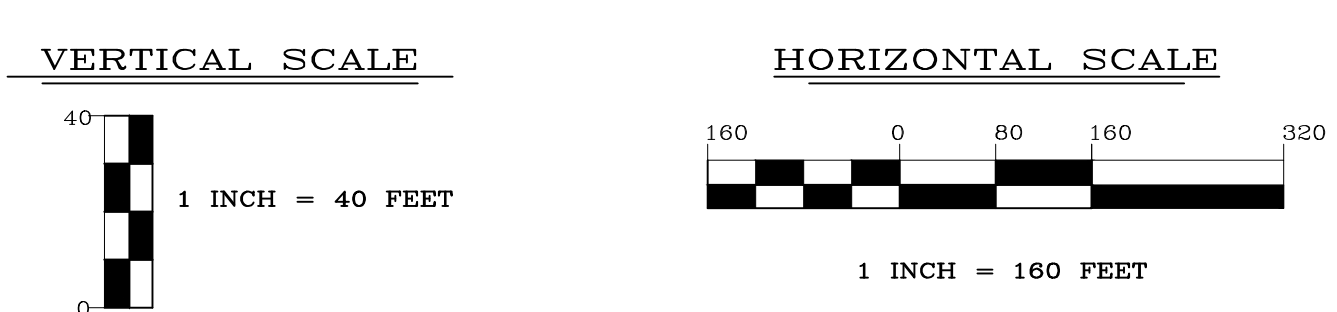

Table with columns: REV, DATE, BY, DESCRIPTION. Includes entries for 'FINAL ANNUAL REPORT DRAFT ISSUED FOR REVIEW' and 'DRAFT ISSUED FOR REVIEW'.

DRAWING TITLE: NUTLEY SITE REMEDIATION PROJECT
PROJECT TITLE: FIGURE 39 VERTICAL GROUNDWATER FLOW CROSS-SECTION A-A' MEASURED 06-02-14
SCALE: AS SHOWN
BLOC. NO.
PREPARED FOR: Hoffmann-La Roche Inc.
DRAWING NO.: NR-STE-S29215-C1209