

CROSS-SECTION LOCATION

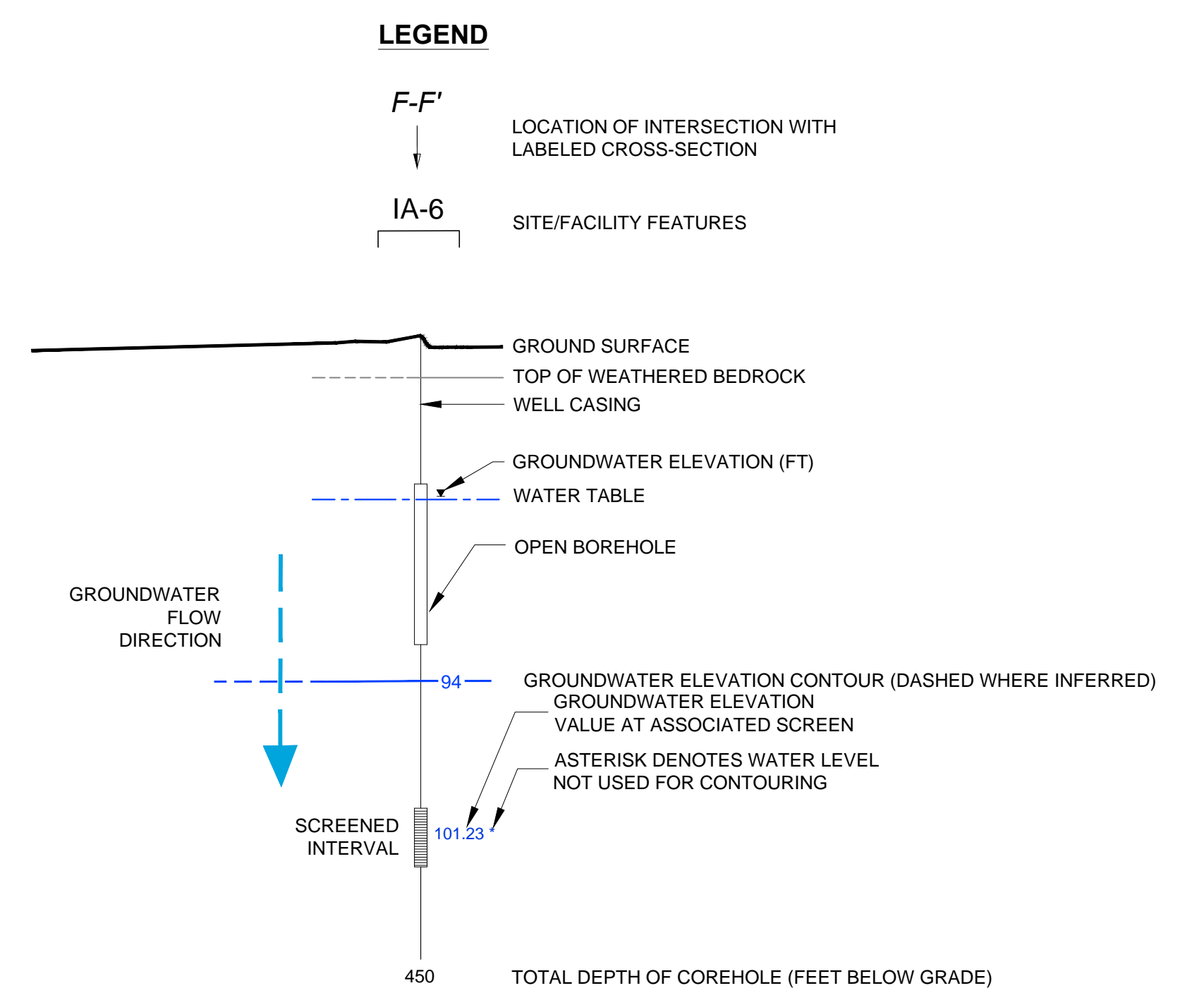
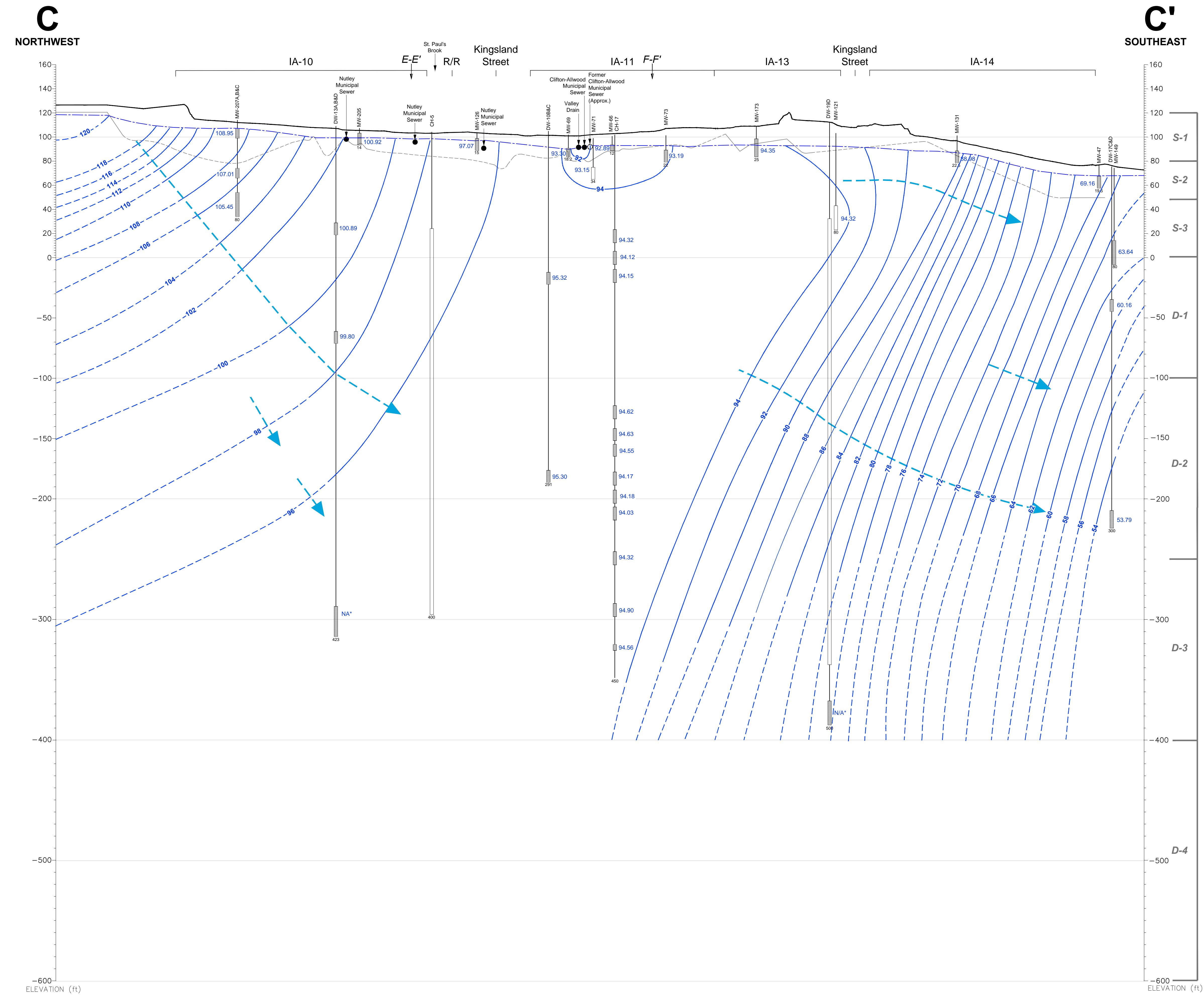
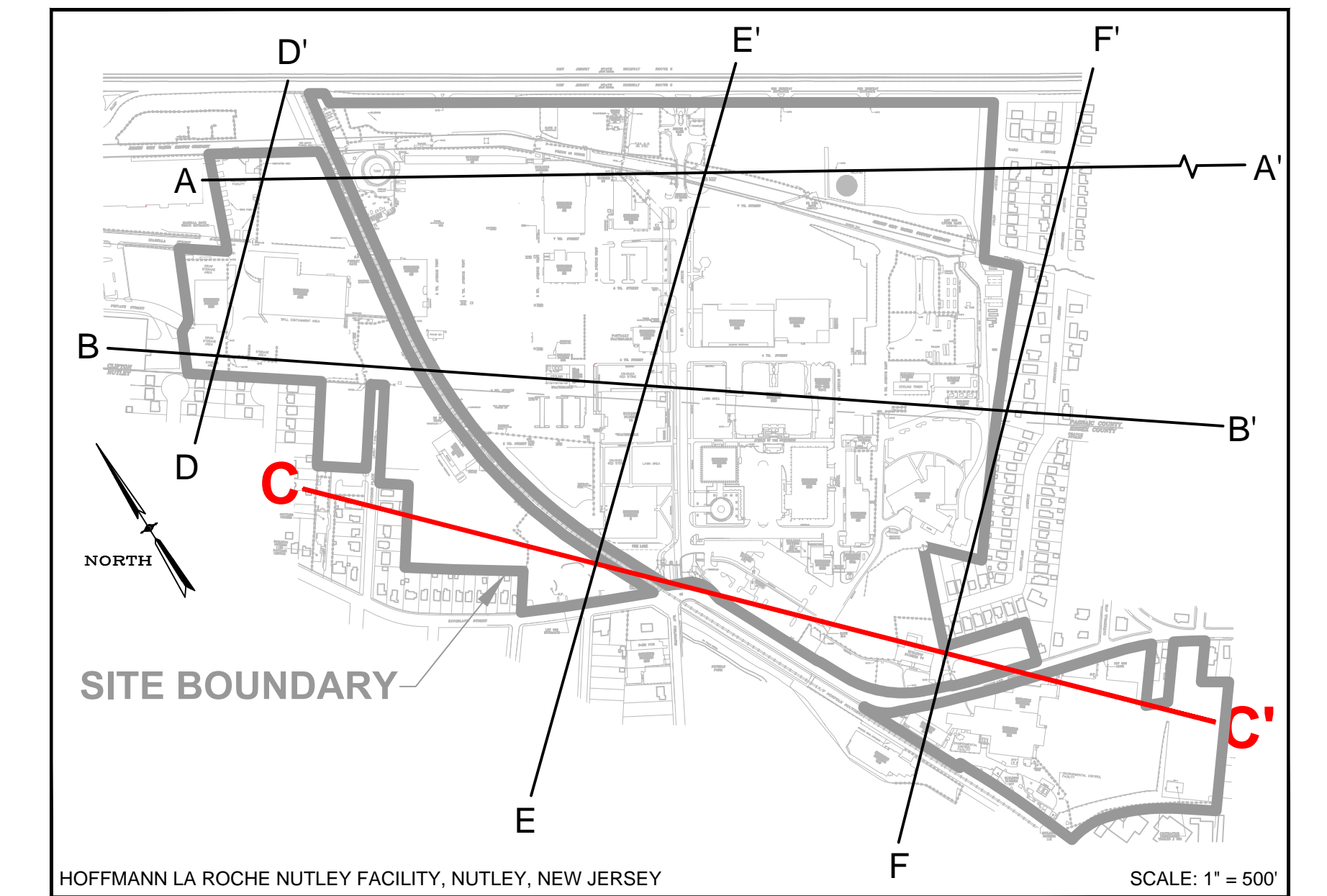

- NOTES:**
- GROUND SURFACE IS BASED UPON THE SURFACE ELEVATION ALONG C-C'.
 - COREHOLES ARE SEALED WITH BLANK FLUTE LINERS EXCEPT CH-17 WHICH HAS A MULTILEVEL.
 - SOME WELLS HAVE BEEN PROJECTED UP TO 300 FEET TO CONSTRUCT THIS VERTICAL SECTION AND ARE DISPLAYED AT ACTUAL SURVEYED ELEVATIONS.
 - LITHOLOGIC CONTACTS ARE DASHED WHERE INFERRED.
 - ELEVATION DATUM NAVD 1988; FEET ABOVE MEAN SEA LEVEL.
 - R/R = RAILROAD.
 - NA = GROUNDWATER ELEVATION NOT AVAILABLE.

ENGINEER IN RESPONSIBLE CHARGE OF THE WORK SHOWN ON THIS DRAWING

DATE: _____ SIGNATURE: _____

PROFESSIONAL ENGINEER: _____ LIC. # _____

TRC ENVIRONMENTAL CORP.
41 SPRING STREET
NEW PROVIDENCE, NEW JERSEY 07974
908-988-1700

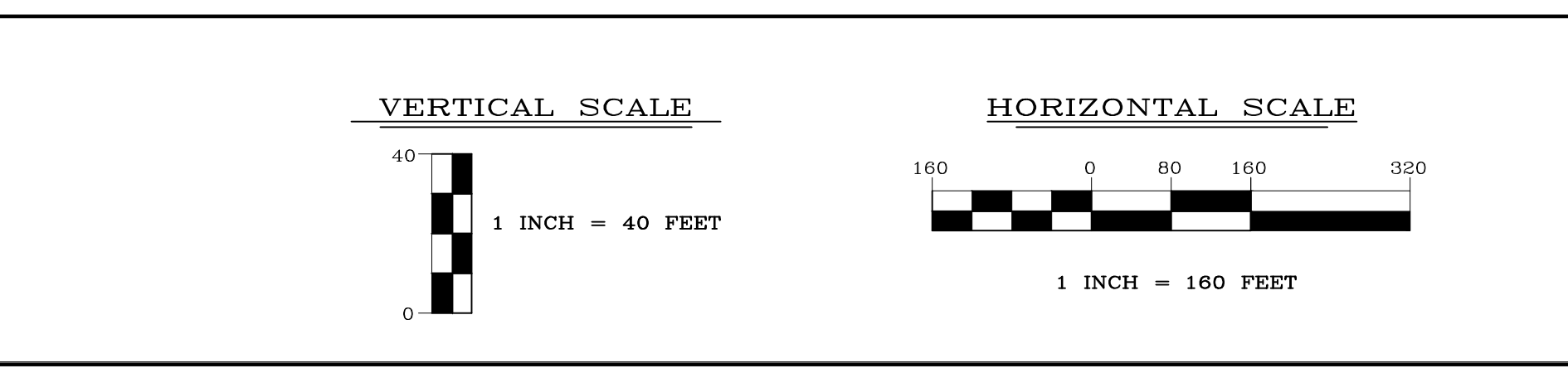

REV	DATE	BY	DESCRIPTION
1	09/30/14	DS	FINAL ANNUAL REPORT DRAFT ISSUED FOR REVIEW
0	03/05/14	DS	DRAFT ISSUED FOR REVIEW

DRAWING TITLE: NUTLEY SITE REMEDIATION PROJECT

PROJECT TITLE: FIGURE 36 VERTICAL GROUNDWATER FLOW CROSS-SECTION C-C' MEASURED 03-17-14

SCALE: AS SHOWN BLDG. NO.

DESIGNED BY: T O'MEARA
CHECKED BY: J STEHLE
DRAWN BY: J STEHLE
PROJECT ENGINEER: G CIERPIAL

PREPARED FOR: Hoffmann-La Roche Inc. 340 KINGSLAND STREET NUTLEY, NEW JERSEY 07110-1199

DRAWING NO.: NR-STE-S29215-C1048

FILE: C:\Users\jgordon\My Documents\LOCAL\TEMP\APR08\K0251196231 0000 205 01 10 V04 102.dwg DATE: 12/10/2014 10:42:29AM