

CROSS-SECTION LOCATION

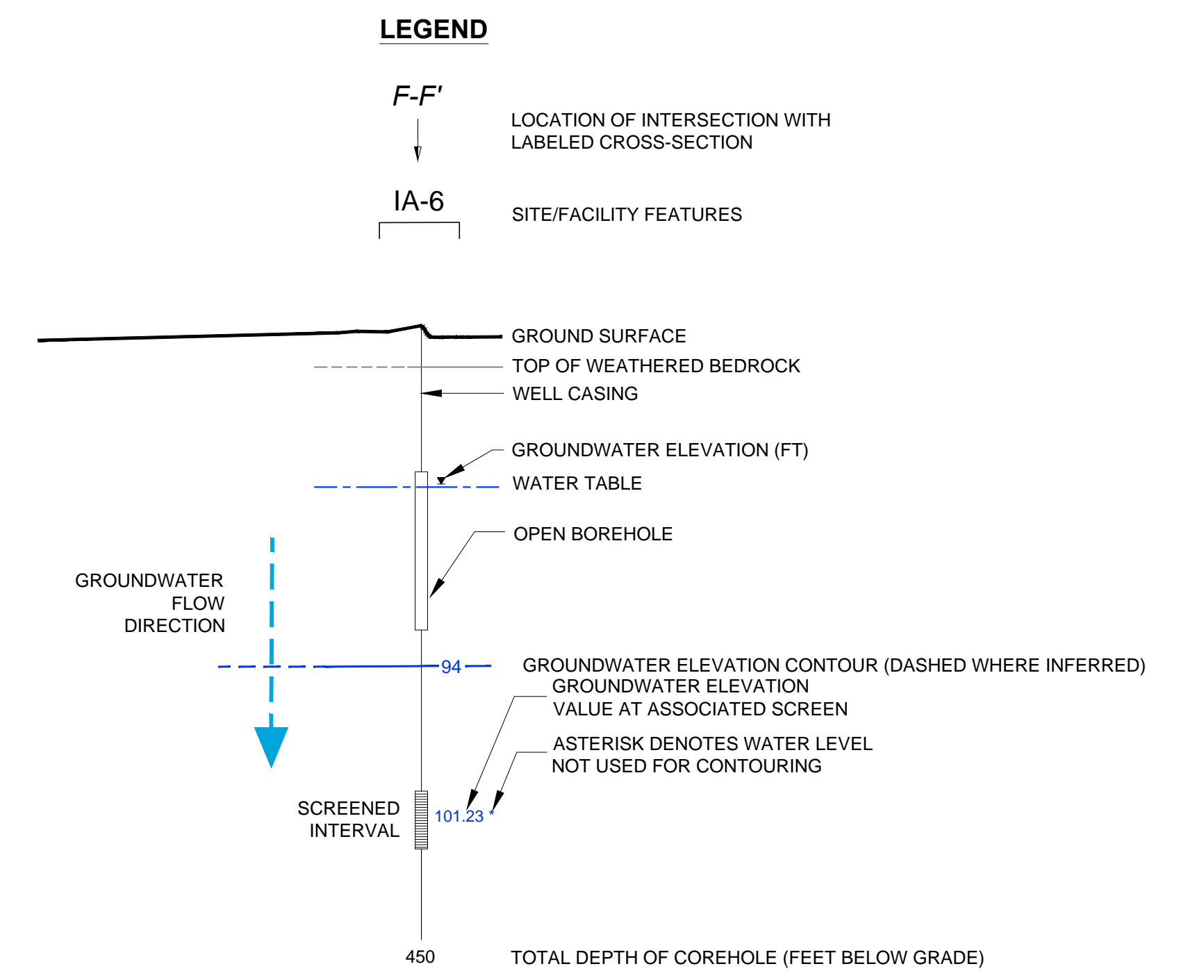
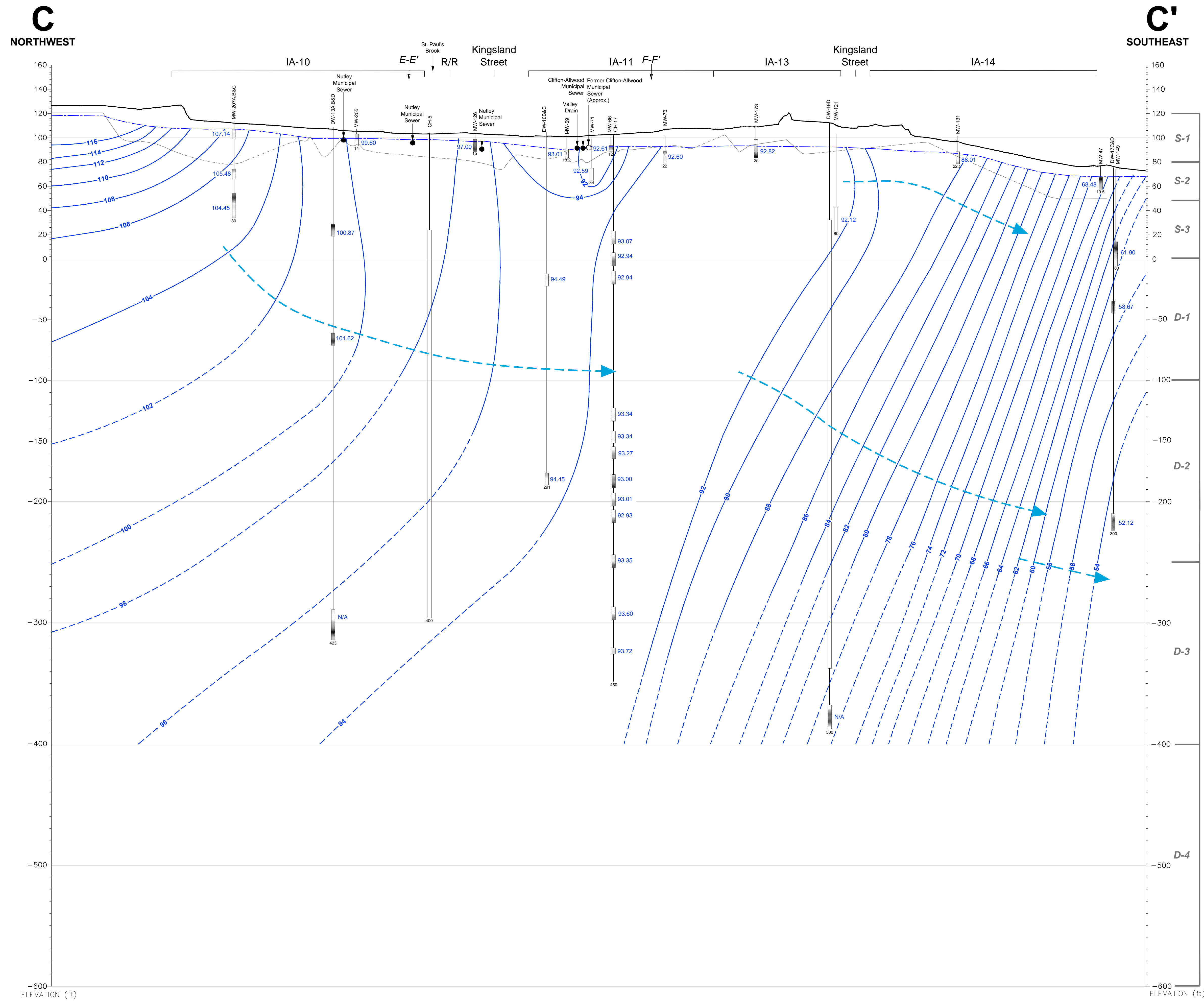
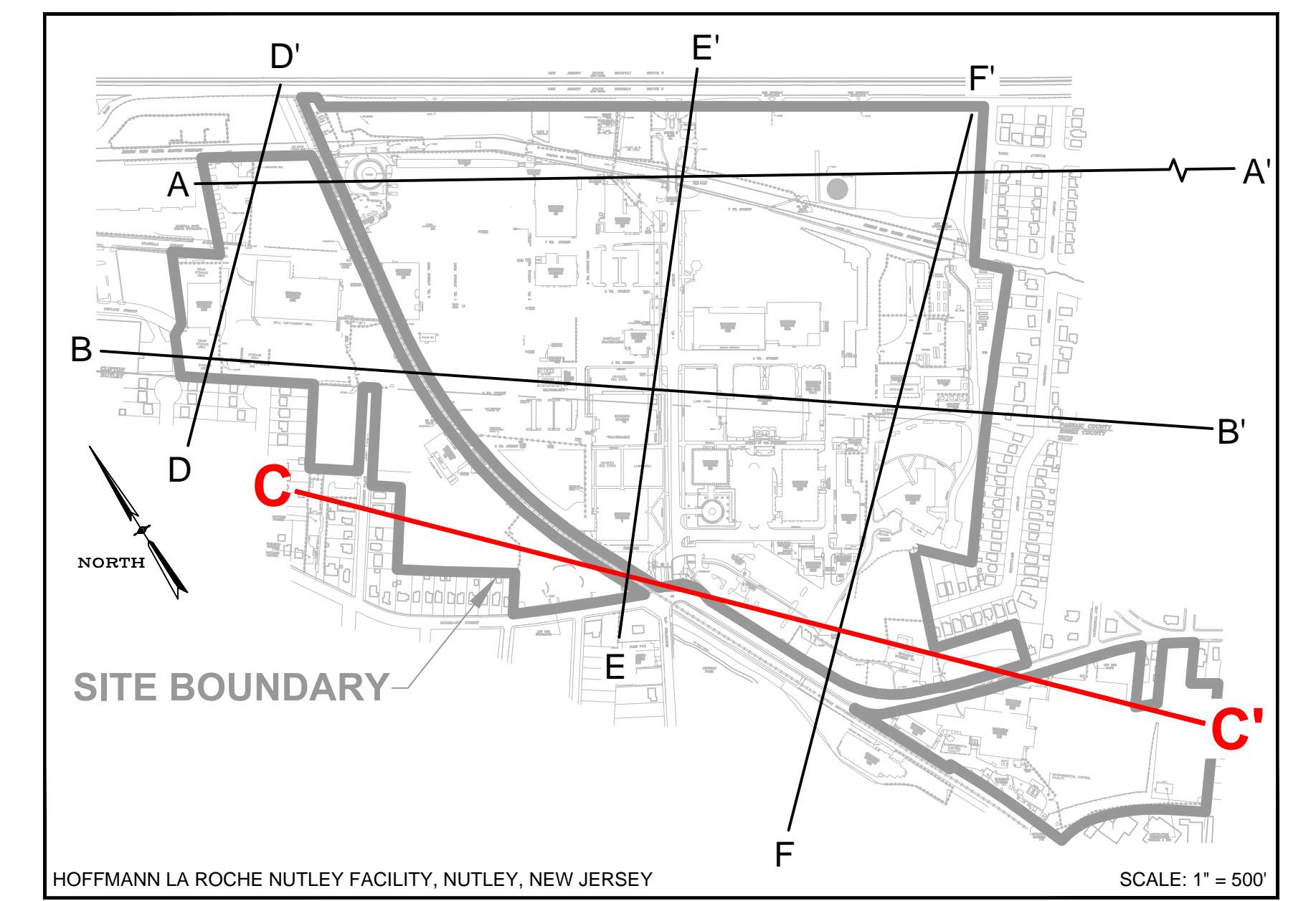

NOTES:

- GROUND SURFACE IS BASED UPON THE SURFACE ELEVATION ALONG C-C'.
- COREHOLES ARE SEALED WITH BLANK FLUTE LINERS EXCEPT CH-17 WHICH HAS A MULTI-LEVEL.
- SOME WELLS HAVE BEEN PROJECTED UP TO 300 FEET TO CONSTRUCT THIS VERTICAL SECTION AND ARE DISPLAYED AT ACTUAL SURVEYED ELEVATIONS.
- LITHOLOGIC CONTACTS ARE DASHED WHERE INFERRED.
- ELEVATION DATUM NGVD 1988; FEET ABOVE MEAN SEA LEVEL.
- R/R = RAILROAD.
- N/A = GROUNDWATER ELEVATION NOT AVAILABLE.

ENGINEER IN RESPONSIBLE CHARGE OF THE WORK SHOWN ON THIS DRAWING

DATE: _____ SIGNATURE: _____

PROFESSIONAL ENGINEER:

LIC. # _____

TRC
 TRC ENVIRONMENTAL CORP.
 41 SPRING STREET
 NEW PROVIDENCE, NEW JERSEY 07974
 908-988-1700

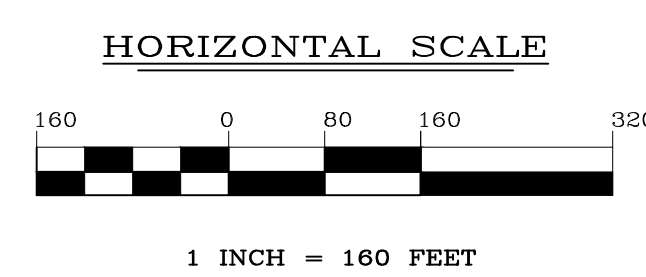
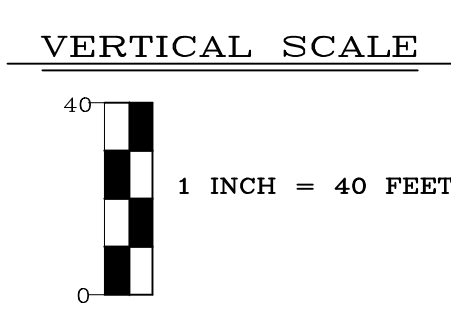

REV	DATE	BY	DESCRIPTION
1	09/30/14	DS	FINAL ANNUAL REPORT DRAFT ISSUED FOR REVIEW
0	03/05/14	DS	DRAFT ISSUED FOR REVIEW

DESIGN SUPERVISOR T. O'MEARA	DRAWN BY J. ESTEVE	CHECKED BY S. SIMON	PROJECT NUMBER GCIERPIAL
---------------------------------	-----------------------	------------------------	-----------------------------

PROJECT TITLE NUTLEY SITE REMEDIATION PROJECT	FIGURE 31 VERTICAL GROUNDWATER FLOW CROSS-SECTION C-C' MEASURED 12-12-13	SCALE AS SHOWN BLDG. NO.
PREPARED FOR Hoffmann-La Roche Inc. 340 KINGSLAND STREET NUTLEY, NEW JERSEY 07110-1199	DRAWING NO. NR-STE-S29215-C989	