

CROSS-SECTION LOCATION

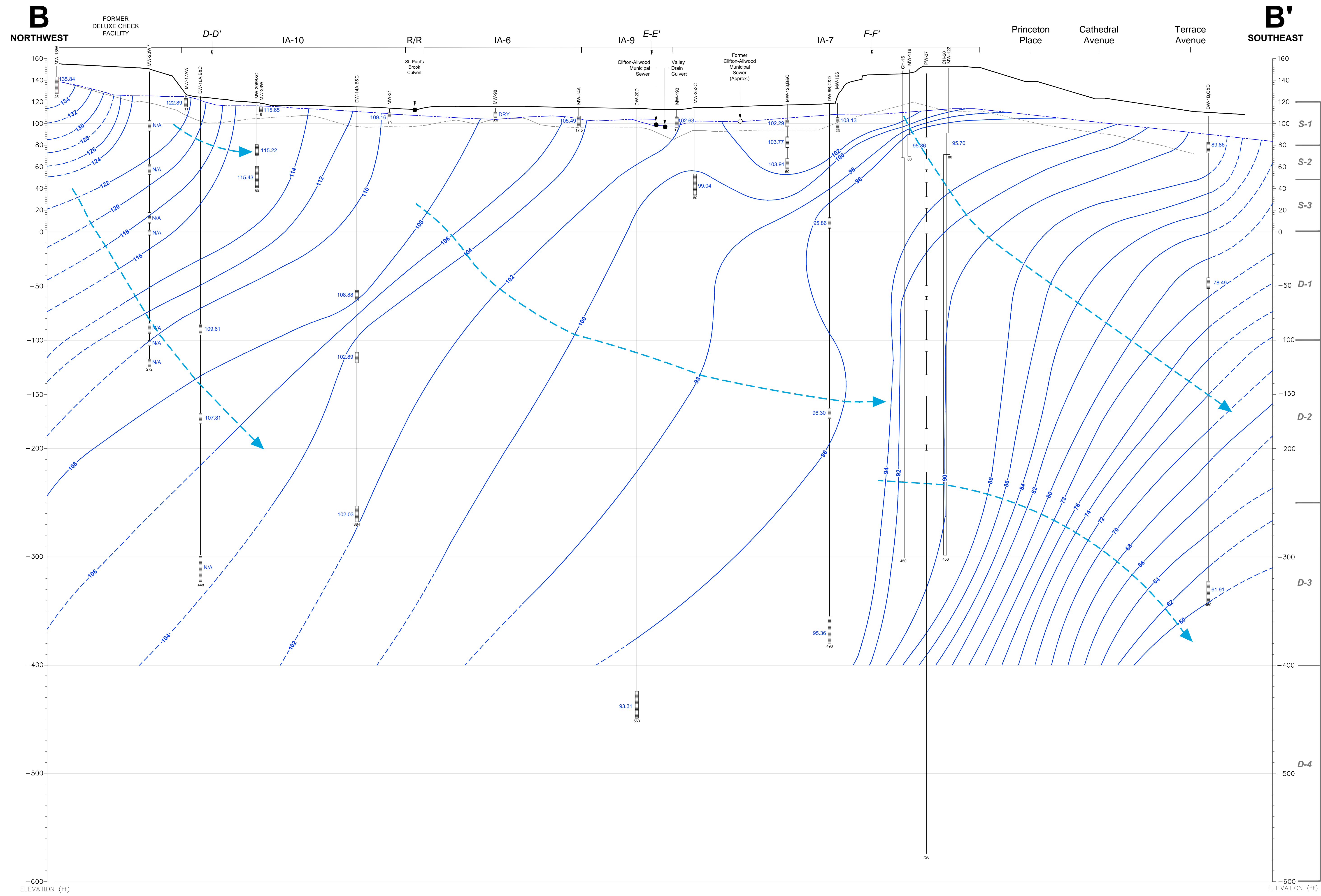

LEGEND

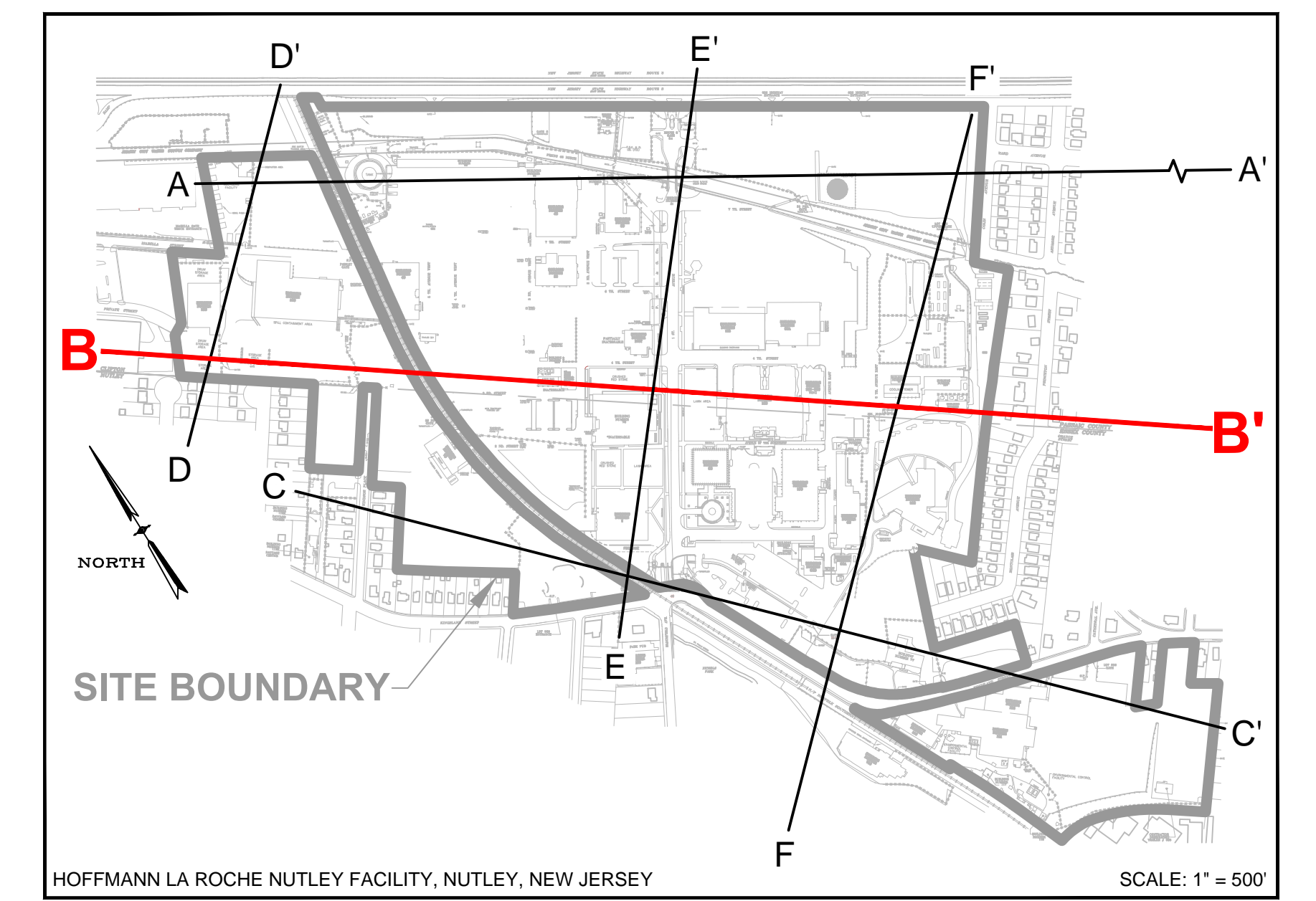
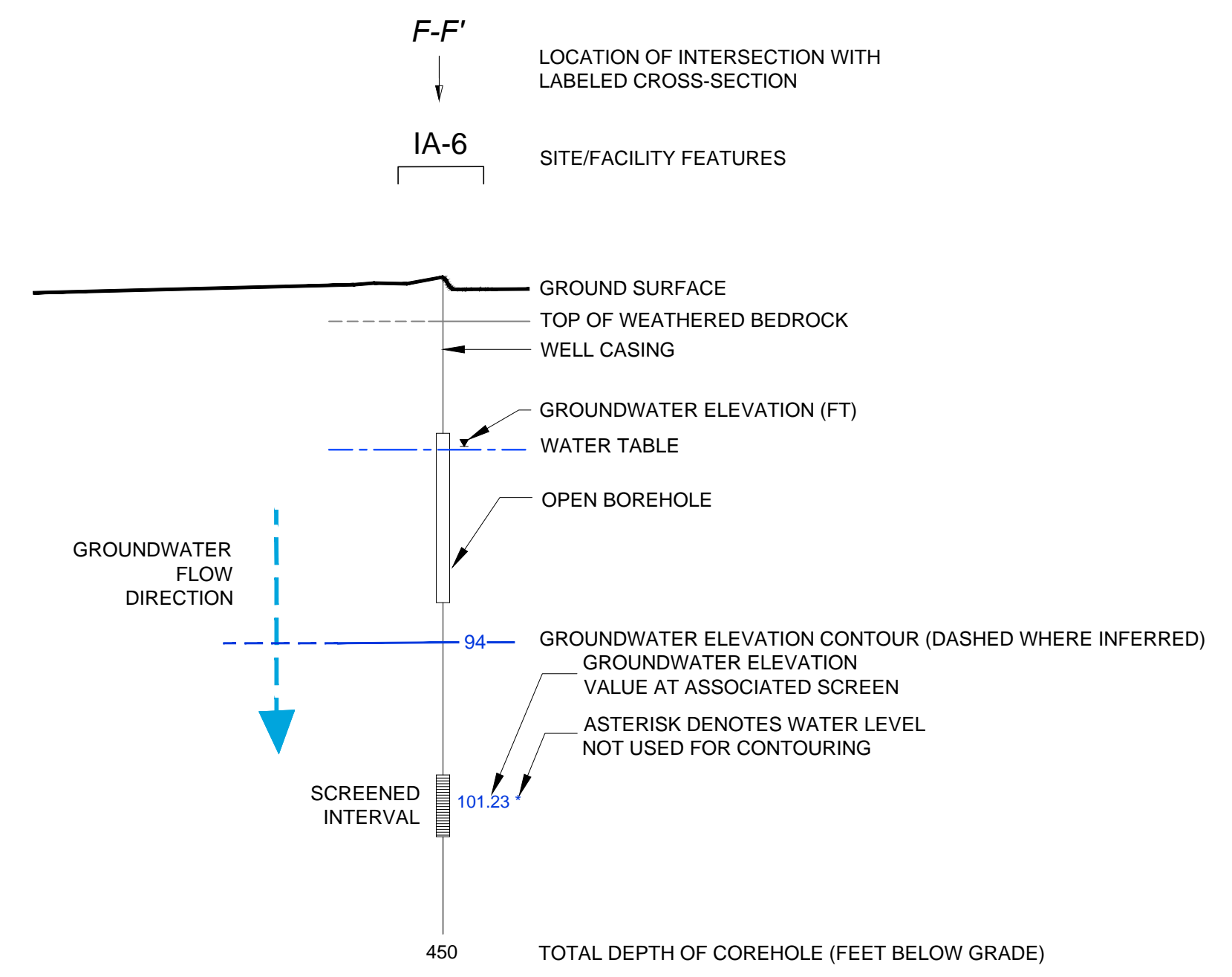

NOTES:

- COREHOLES ARE SEALED WITH BLANK FLUTE LINERS EXCEPT PW-37 WHICH HAS A MULTI-LEVEL FLUTE.
- GROUND SURFACE IS BASED UPON THE SURFACE ELEVATION ALONG B-B' EXCEPT WEST OF MW-17AW WHERE THE GROUND SURFACE ELEVATION IS BASED UPON SURVEYED GROUND SURFACE AT WELL LOCATIONS.
- SOME WELLS HAVE BEEN PROJECTED UP TO 300 FEET TO CONSTRUCT THIS VERTICAL SECTION AND ARE DISPLAYED AT ACTUAL SURVEYED ELEVATIONS.
- LITHOLOGIC CONTACTS ARE DASHED WHERE INFERRED.
- ELEVATION DATUM NAVD 1988, FEET ABOVE MEAN SEA LEVEL.
- R/R = RAILROAD.
- PW-37 SHOWN FOR LOCATION PURPOSES ONLY.
- N/A = GROUNDWATER ELEVATION NOT AVAILABLE.

ENGINEER IN RESPONSIBLE CHARGE OF THE WORK SHOWN ON THIS DRAWING
 DATE: _____ SIGNATURE: _____
 PROFESSIONAL ENGINEER LIC. # _____

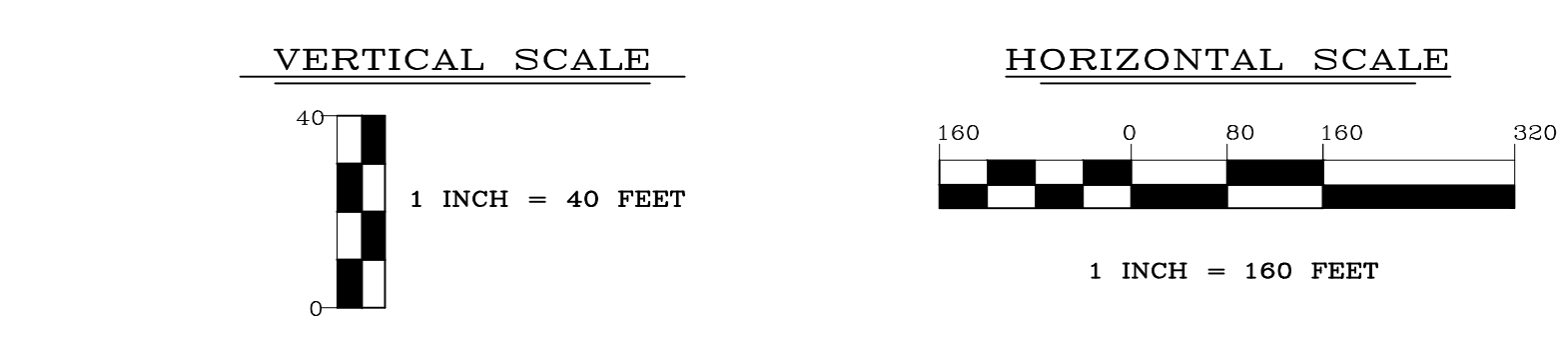

REV	DATE	BY	DESCRIPTION
1	09/30/14	DS	FINAL ANNUAL REPORT DRAFT ISSUED FOR REVIEW
0	03/05/14	DS	DRAFT ISSUED FOR REVIEW

DRAWING TITLE: NUTLEY SITE REMEDIATION PROJECT
 PROJECT TITLE: FIGURE 30 VERTICAL GROUNDWATER FLOW CROSS-SECTION B-B' MEASURED 12-12-13
 SCALE: AS SHOWN
 BLDG. NO.:
 DESIGNED BY: J. STEHLE
 CHECKED BY: S. CHERAY
 PROJECT NUMBER: GCIERPIAL
 PREPARED FOR: Hoffmann-La Roche Inc., 340 KINGSLAND STREET, NUTLEY, NEW JERSEY 07110-1199
 DRAWING NO.: NR-STE-S29215-C988

FILE: C:\USERS\JG\PROJECTS\NUTLEY\LOCAL\TEMP\APRIL_2015\196231_0000_205_01_10_V14_422.dwg, DATE: 12/10/2014 08:53:09AM