

NOTE:
1. ONLY THE MOST RECENT GAUGING RESULTS ARE LABELED IN THE GRAPH.

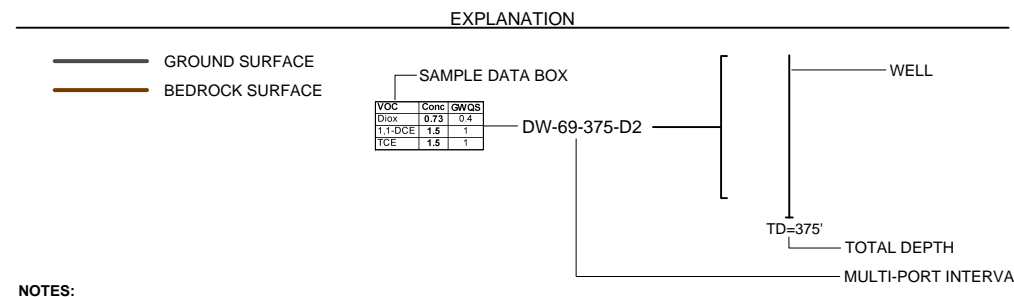

- NOTES:**
- VOC = VOLATILE ORGANIC COMPOUNDS.
 - MULTI-PORT GROUNDWATER QUALITY DATA WAS COLLECTED IN FEBRUARY, MARCH, APRIL, AND MAY 2017.
 - GWQS = NJDEP GROUND WATER QUALITY STANDARD.
 - DIOX = 1,4-DIOXANE.
 - 1,1-DCE = 1,1-DICHLOROETHENE.
 - PCE = TETRACHLOROETHENE.
 - TCE = TRICHLOROETHENE.
 - ALL CONCENTRATIONS ARE IN PARTS PER BILLION (PPB).
 - NE = VOCs DO NOT EXCEED THE GWQS.

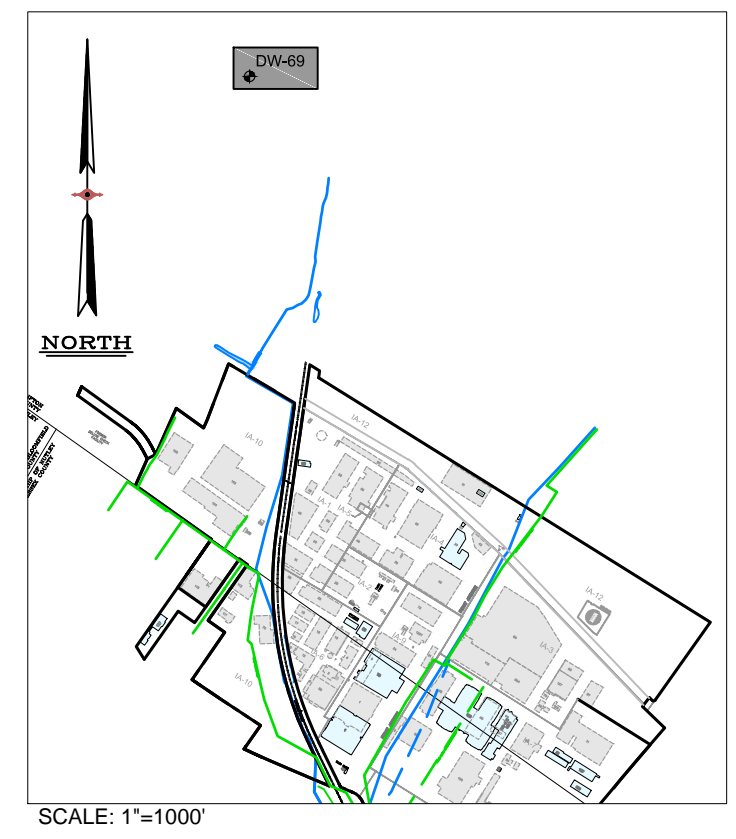

ENGINEER IN RESPONSIBLE CHARGE OF THE WORK SHOWN ON THIS DRAWING

DATE: _____ SIGNATURE: _____

PROFESSIONAL ENGINEER: _____ LIC. # _____

TRC

TRC ENVIRONMENTAL CORP.
41 SPRING STREET
NEW PROVIDENCE, NEW JERSEY 07974
908-988-1700

REV	DATE	BY	DESCRIPTION
1	8/28/17	MG	ADDED APRIL AND MAY MULTIPOINT SAMPLING EVENTS
0	3/8/17	MG	DRAFT ISSUED FOR REVIEW

PROJECT TITLE: NUTLEY SITE REMEDIATION PROJECT

DESIGN SUPERVISOR: T. O'MEARA

DESIGNED BY: M. GIAMBATTISTA

CHECKED BY: L. NUNES

START DATE: 2/14/17

SUPERVISOR: D. NACHMAN

PROJECT ENGINEER: G. CIERPAL

DRAWING TITLE: FIGURE 13 DW-69 MULTI-PORT DATA MARCH & APRIL 2017

SCALE: AS SHOWN

BLDG. NO.: -

PREPARED FOR: **Roche** Hoffmann-La Roche Inc. 340 KINGSLAND STREET NUTLEY, NEW JERSEY 07110-1199

DRAWING NO.: NB-STE-S29215-C2746