

| Month    | Conc    | GWQS | Month | Conc       | GWQS    | Month | Conc | GWQS       | Month   | Conc | GWQS |
|----------|---------|------|-------|------------|---------|-------|------|------------|---------|------|------|
| MAY 2017 | Diox    | 19.2 | 0.4   | APRIL 2017 | Diox    | 21.6  | 0.4  | MARCH 2017 | Diox    | 14.5 | 0.4  |
| MAY 2017 | 1,1-DCE | 6.8  | 1     | APRIL 2017 | 1,1-DCE | 6.2   | 1    | MARCH 2017 | 1,1-DCE | 5.8  | 1    |
| MAY 2017 | VC      | 1.9  | 1     | APRIL 2017 | VC      | 1.4   | 1    | MARCH 2017 | VC      | 1.8  | 1    |
| MAY 2017 | Diox    | 38   | 0.4   | APRIL 2017 | Diox    | 44    | 0.4  | MARCH 2017 | Diox    | 28.2 | 0.4  |
| MAY 2017 | 1,1-DCE | 8.2  | 1     | APRIL 2017 | 1,1-DCE | 8.4   | 1    | MARCH 2017 | 1,1-DCE | 9.1  | 1    |
| MAY 2017 | MTBE    | 233  | 1     | APRIL 2017 | MTBE    | 232   | 70   | MARCH 2017 | MTBE    | 237  | 70   |
| MAY 2017 | VC      | 2.3  | 70    | APRIL 2017 | VC      | 2.3   | 1    | MARCH 2017 | VC      | 2.3  | 1    |
| MAY 2017 | Diox    | 37.6 | 0.4   | APRIL 2017 | Diox    | 41.8  | 0.4  | MARCH 2017 | Diox    | 23.6 | 0.4  |
| MAY 2017 | 1,1-DCE | 10.9 | 1     | APRIL 2017 | 1,1-DCE | 8.4   | 1    | MARCH 2017 | 1,1-DCE | 7.3  | 1    |
| MAY 2017 | MTBE    | 211  | 1     | APRIL 2017 | MTBE    | 232   | 70   | MARCH 2017 | MTBE    | 195  | 70   |
| MAY 2017 | VC      | 3    | 70    | APRIL 2017 | VC      | 2.7   | 1    | MARCH 2017 | VC      | 2.7  | 1    |
| MAY 2017 | Diox    | 10.9 | 0.4   | APRIL 2017 | Diox    | 12.3  | 0.4  | MARCH 2017 | Diox    | 8    | 0.4  |
| MAY 2017 | 1,1-DCE | 11.1 | 1     | APRIL 2017 | 1,1-DCE | 13.9  | 1    | MARCH 2017 | 1,1-DCE | 12.7 | 1    |
| MAY 2017 | VC      | 2.3  | 70    | APRIL 2017 | VC      | 1.2   | 1    | MARCH 2017 | VC      | 1.3  | 1    |
| MAY 2017 | Diox    | 24.8 | 0.4   | APRIL 2017 | Diox    | 30.4  | 0.4  | MARCH 2017 | Diox    | 28.8 | 0.4  |
| MAY 2017 | 1,1-DCE | 37.2 | 1     | APRIL 2017 | 1,1-DCE | 2.2   | 1    | MARCH 2017 | 1,1-DCE | 1.9  | 1    |
| MAY 2017 | MTBE    | 208  | 70    | APRIL 2017 | MTBE    | 176   | 70   | MARCH 2017 | MTBE    | 128  | 70   |
| MAY 2017 | TCE     | 1.7  | 1     | APRIL 2017 | TCE     | 1.7   | 1    | MARCH 2017 | TCE     | 1.2  | 1    |
| MAY 2017 | VC      | 2.5  | 1     | APRIL 2017 | VC      | 2.3   | 1    | MARCH 2017 | VC      | 2.3  | 1    |
| MAY 2017 | Diox    | 33   | 0.4   | APRIL 2017 | Diox    | 28.9  | 0.4  | MARCH 2017 | Diox    | 20.6 | 0.4  |
| MAY 2017 | 1,1-DCE | 2.7  | 1     | APRIL 2017 | 1,1-DCE | 2.3   | 1    | MARCH 2017 | 1,1-DCE | 9    | 1    |
| MAY 2017 | Diox    | 103  | 0.4   | APRIL 2017 | Diox    | 149   | 0.4  | MARCH 2017 | Diox    | 120  | 0.4  |
| MAY 2017 | Diox    | 165  | 0.4   | APRIL 2017 | Diox    | 262   | 0.4  | MARCH 2017 | Diox    | 229  | 0.4  |
| MAY 2017 | Diox    | 181  | 0.4   | APRIL 2017 | Diox    | 304   | 0.4  | MARCH 2017 | Diox    | 242  | 0.4  |
| MAY 2017 | Diox    | 116  | 0.4   | APRIL 2017 | Diox    | 273   | 0.4  | MARCH 2017 | Diox    | 125  | 0.4  |
| MAY 2017 | Diox    | 53   | 0.4   | APRIL 2017 | Diox    | 214   | 0.4  | MARCH 2017 | Diox    | 145  | 0.4  |
| MAY 2017 | Diox    | 89   | 0.4   | APRIL 2017 | Diox    | 94.7  | 0.4  | MARCH 2017 | Diox    | 85.9 | 0.4  |
| MAY 2017 | 1,1-DCE | 1.8  | 1     | APRIL 2017 | 1,1-DCE | 63    | 0.4  | MARCH 2017 | 1,1-DCE | 46.7 | 0.4  |
| MAY 2017 | Diox    | 38.9 | 0.4   | APRIL 2017 | Diox    | 54.1  | 0.4  | MARCH 2017 | Diox    | 49.5 | 0.4  |
| MAY 2017 | 1,1-DCE | 2.3  | 1     | APRIL 2017 | 1,1-DCE | 1.8   | 1    | MARCH 2017 | 1,1-DCE | 1.8  | 1    |
| MAY 2017 | PCE     | 3.8  | 1     | APRIL 2017 | PCE     | 4     | 1    | MARCH 2017 | PCE     | 4    | 1    |
| MAY 2017 | TCE     | 1.2  | 1     | APRIL 2017 | TCE     | 1.2   | 1    | MARCH 2017 | TCE     | 1.3  | 1    |
| MAY 2017 | Diox    | 84.2 | 0.4   | APRIL 2017 | Diox    | 136   | 0.4  | MARCH 2017 | Diox    | 85.9 | 0.4  |
| MAY 2017 | PCE     | 1.4  | 1     | APRIL 2017 | PCE     | 1.1   | 1    | MARCH 2017 | PCE     | 1.1  | 1    |
| MAY 2017 | TCE     | 1.3  | 1     | APRIL 2017 | TCE     | 1.1   | 1    | MARCH 2017 | TCE     | 1.1  | 1    |
| MAY 2017 | Diox    | 70.2 | 0.4   | APRIL 2017 | Diox    | 106   | 0.4  | MARCH 2017 | Diox    | 79.2 | 0.4  |
| MAY 2017 | PCE     | 1.3  | 1     | APRIL 2017 | PCE     | 1.3   | 1    | MARCH 2017 | PCE     | 1.2  | 1    |
| MAY 2017 | TCE     | 1.6  | 1     | APRIL 2017 | TCE     | 1.7   | 1    | MARCH 2017 | TCE     | 1.5  | 1    |
| MAY 2017 | Diox    | 87.2 | 0.4   | APRIL 2017 | Diox    | 138   | 0.4  | MARCH 2017 | Diox    | 93.2 | 0.4  |
| MAY 2017 | 1,1-DCE | 1.4  | 1     | APRIL 2017 | 1,1-DCE | 1.2   | 1    | MARCH 2017 | 1,1-DCE | 1.2  | 1    |
| MAY 2017 | TCE     | 1.4  | 1     | APRIL 2017 | TCE     | 1.7   | 1    | MARCH 2017 | TCE     | 1.7  | 1    |
| MAY 2017 | Diox    | 88.3 | 0.4   | APRIL 2017 | Diox    | 131   | 0.4  | MARCH 2017 | Diox    | 91.9 | 0.4  |
| MAY 2017 | Diox    | 28.1 | 0.4   | APRIL 2017 | Diox    | 43    | 0.4  | MARCH 2017 | Diox    | 46.9 | 0.4  |
| MAY 2017 | 1,1-DCE | 3.3  | 1     | APRIL 2017 | 1,1-DCE | 2.8   | 1    | MARCH 2017 | 1,1-DCE | 2.8  | 1    |
| MAY 2017 | PCE     | 4.6  | 1     | APRIL 2017 | PCE     | 4.8   | 1    | MARCH 2017 | PCE     | 4.9  | 1    |
| MAY 2017 | TCE     | 12.7 | 1     | APRIL 2017 | TCE     | 12.4  | 1    | MARCH 2017 | TCE     | 12.1 | 1    |
| MAY 2017 | Diox    | 18.7 | 0.4   | APRIL 2017 | Diox    | 19.8  | 0.4  | MARCH 2017 | Diox    | 17.9 | 0.4  |
| MAY 2017 | 1,1-DCE | 21.1 | 2     | APRIL 2017 | 1,1-DCE | 26.1  | 2    | MARCH 2017 | 1,1-DCE | 16   | 2    |
| MAY 2017 | 1,1-DCE | 4.8  | 1     | APRIL 2017 | 1,1-DCE | 4.3   | 1    | MARCH 2017 | 1,1-DCE | 2.6  | 1    |
| MAY 2017 | PCE     | 4.2  | 1     | APRIL 2017 | PCE     | 3.1   | 1    | MARCH 2017 | PCE     | 3.7  | 1    |
| MAY 2017 | TCE     | 15.9 | 1     | APRIL 2017 | TCE     | 17.1  | 1    | MARCH 2017 | TCE     | 11.3 | 1    |
| MAY 2017 | Diox    | 7.4  | 0.4   | APRIL 2017 | Diox    | 13    | 0.4  | MARCH 2017 | Diox    | 8.2  | 0.4  |
| MAY 2017 | 1,1-DCE | 23.8 | 2     | APRIL 2017 | 1,1-DCE | 24.7  | 2    | MARCH 2017 | 1,1-DCE | 23.7 | 2    |
| MAY 2017 | PCE     | 4    | 1     | APRIL 2017 | PCE     | 3.1   | 1    | MARCH 2017 | PCE     | 3.7  | 1    |
| MAY 2017 | TCE     | 18.3 | 1     | APRIL 2017 | TCE     | 14.4  | 1    | MARCH 2017 | TCE     | 16.8 | 1    |
| MAY 2017 | Diox    | 37   | 0.4   | APRIL 2017 | Diox    | 45.3  | 0.4  | MARCH 2017 | Diox    | 43.8 | 0.4  |
| MAY 2017 | 1,1-DCE | 7    | 2     | APRIL 2017 | 1,1-DCE | 7.6   | 2    | MARCH 2017 | 1,1-DCE | 8.2  | 2    |
| MAY 2017 | 1,1-DCE | 4    | 1     | APRIL 2017 | 1,1-DCE | 3     | 1    | MARCH 2017 | 1,1-DCE | 2.8  | 1    |
| MAY 2017 | PCE     | 1.5  | 1     | APRIL 2017 | PCE     | 1.6   | 1    | MARCH 2017 | PCE     | 1.6  | 1    |
| MAY 2017 | TCE     | 6.2  | 1     | APRIL 2017 | TCE     | 5.8   | 1    | MARCH 2017 | TCE     | 5.8  | 1    |
| MAY 2017 | Diox    | 35.9 | 0.4   | APRIL 2017 | Diox    | 65.3  | 0.4  | MARCH 2017 | Diox    | 43.6 | 0.4  |
| MAY 2017 | 1,1-DCE | 4.6  | 2     | APRIL 2017 | 1,1-DCE | 5.3   | 2    | MARCH 2017 | 1,1-DCE | 6.7  | 2    |
| MAY 2017 | TCE     | 1.5  | 1     | APRIL 2017 | TCE     | 2.2   | 1    | MARCH 2017 | TCE     | 2.3  | 1    |
| MAY 2017 | Diox    | 39.3 | 0.4   | APRIL 2017 | Diox    | 68.4  | 0.4  | MARCH 2017 | Diox    | 62.7 | 0.4  |
| MAY 2017 | 1,1-DCE | 4.1  | 2     | APRIL 2017 | 1,1-DCE | 4.7   | 2    | MARCH 2017 | 1,1-DCE | 6.2  | 2    |
| MAY 2017 | TCE     | 1.3  | 1     | APRIL 2017 | TCE     | 1.3   | 1    | MARCH 2017 | TCE     | 1.3  | 1    |

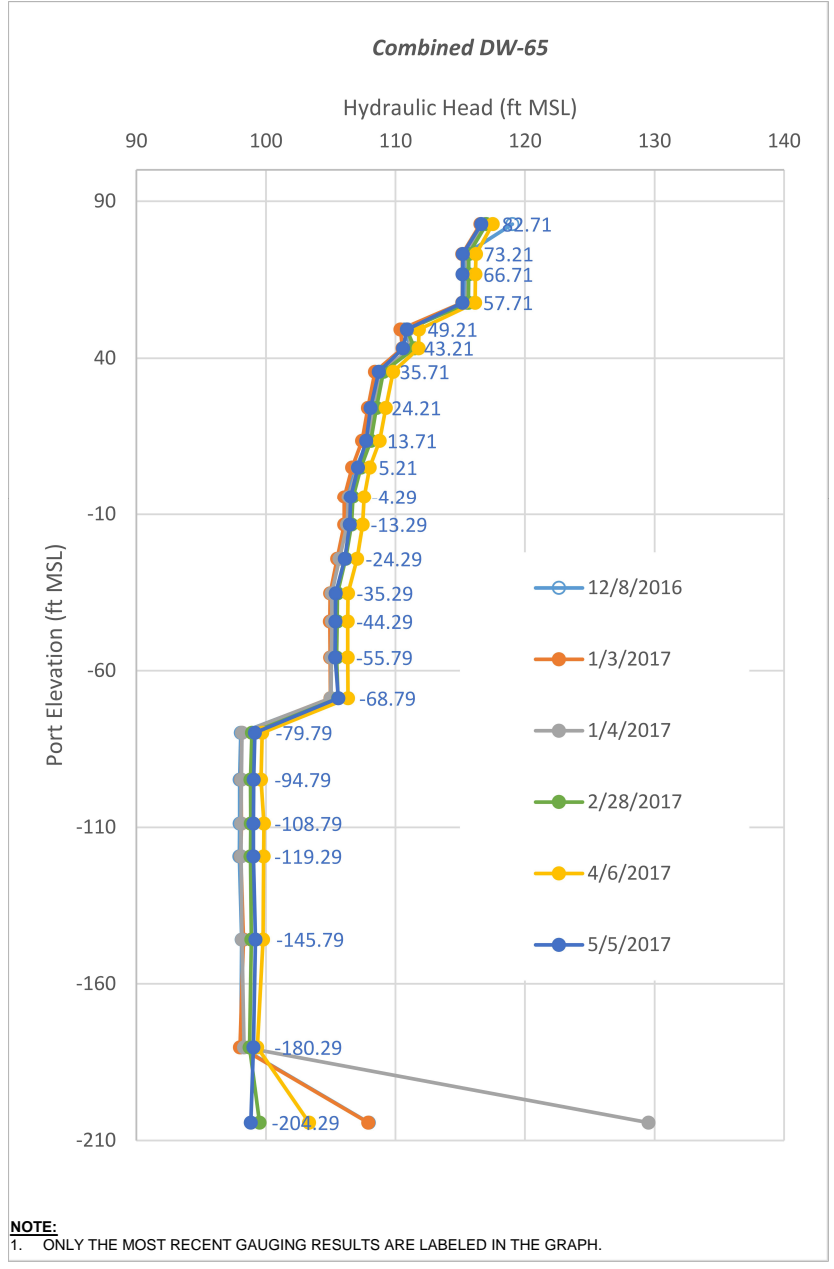
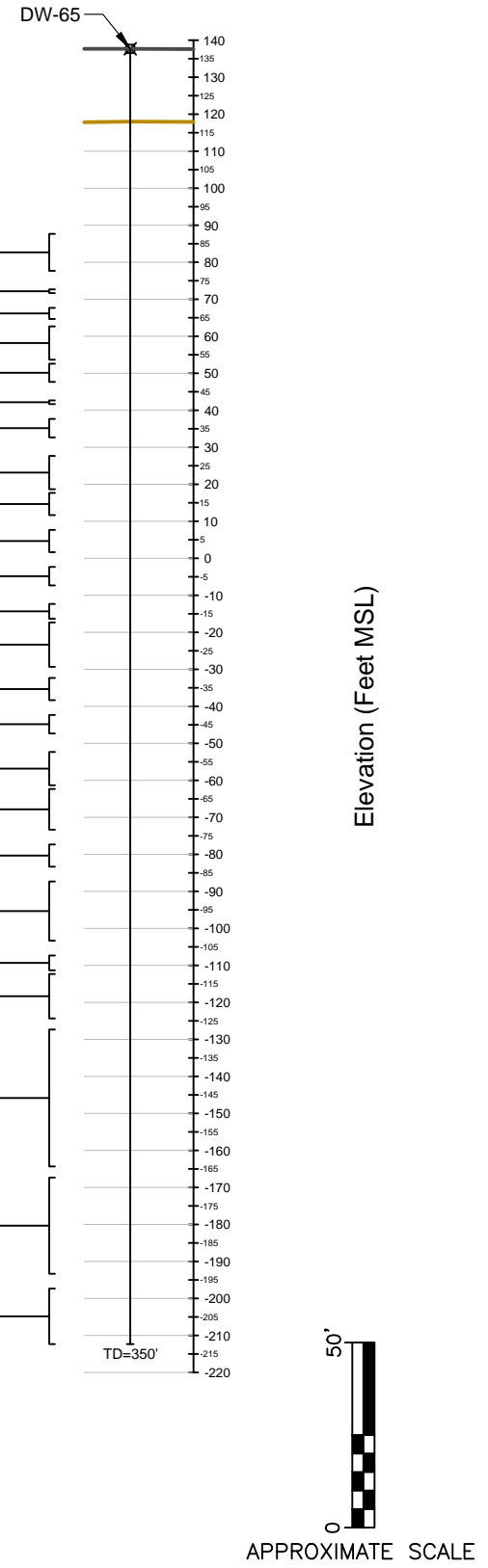

**EXPLANATION**

- GROUND SURFACE
- BEDROCK SURFACE
- WELL
- TOTAL DEPTH
- MULTI-PORT INTERVAL

**NOTES:**

- VOC = VOLATILE ORGANIC COMPOUNDS.
- MULTI-PORT DATA WAS COLLECTED JANUARY, MARCH, APRIL, AND MAY 2017.
- GWQS = NJDEP GROUND WATER QUALITY STANDARD.
- DIOX = 1,4-DIOXANE.
- 1,2-DCA = 1,2-DICHLOROETHANE.
- 1,1-DCE = 1,1-DICHLOROETHENE.
- PCE = TETRACHLOROETHENE.
- TCE = TRICHLOROETHENE.
- MTBE = METHYL TERT BUTYL ETHER.
- ALL CONCENTRATIONS ARE IN PARTS PER BILLION (PPB).
- NS = NOT SAMPLED.

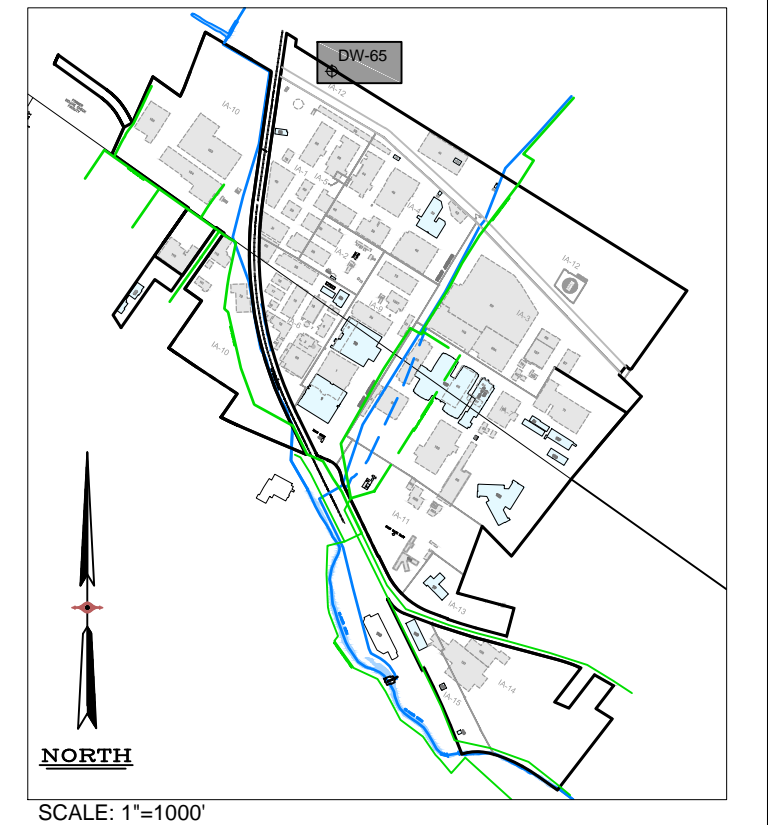

ENGINEER IN RESPONSIBLE CHARGE OF THE WORK SHOWN ON THIS DRAWING

DATE: \_\_\_\_\_ SIGNATURE: \_\_\_\_\_

PROFESSIONAL ENGINEER: \_\_\_\_\_

LIC. # \_\_\_\_\_

**TRC**

TRC ENVIRONMENTAL CORP.  
41 SPRING STREET  
NEW PROVIDENCE, NEW JERSEY 07974  
908-988-1700

| REV | DATE    | BY | DESCRIPTION                                    |
|-----|---------|----|------------------------------------------------|
| 1   | 8/28/17 | MG | ADDED APRIL AND MAY MULTIPOINT SAMPLING EVENTS |
| 0   | 3/9/17  | MG | DRAFT ISSUED FOR REVIEW                        |

PROJECT TITLE: NUTLEY SITE REMEDIATION PROJECT

INITIATOR: T. O'MEARA

DRAWN BY: M. GIAMBATTISTA

CHECKED BY: L. NUNES

START DATE: 1/4/17

SUPERVISOR: D. NACHMAN

PROJECT ENGINEER: G. CIERPAL

DESIGN SUPERVISOR: \_\_\_\_\_

PROJECT ENGINEER: \_\_\_\_\_

DRAWING TITLE: FIGURE 12 DW-65 MULTI-PORT DATA DECEMBER 2016 - MAY 2017

SCALE: AS SHOWN

BLDG. NO.: -

PREPARED FOR: **Roche** Hoffmann-La Roche Inc. 340 KINGSLAND STREET NUTLEY, NEW JERSEY 07110-1199

DRAWING NO.: NB-STE-S29215-C2742